

# appendix B

## IN THIS APPENDIX:

---

# Local Project Factsheets

---

"Local Projects", details pedestrian and local bikeway recommendations for 22 focus areas, including the eight schools covered by this plan. Each focus area will have its own factsheet including a description of the focus area, a location map, and recommendations.

### **Safe Routes to School Focus Areas**

- Friendly Hills Elementary School
- La Contenta Middle School & Black Rock High School
- Landers Elementary School
- Morongo Valley Elementary School
- Twentynine Palms High School
- Twentynine Palms Junior High School
- Yucca Mesa Elementary School

### **Other Pedestrian and Bicycle Focus Areas**

- Adobe Road & State Route 62
- Baseline Road & Utah Trail
- Copper Mountain College
- El Paseo Drive & Hillside Avenue
- State Route 62 & Avalon Avenue
- State Route 62 & Park Avenue
- State Route 62 & Warren Vista Drive
- Onaga Trail & Balsa Avenue
- Onaga Trail & Hopi Trail
- Onaga Trail & Sage Avenue
- Palm Avenue & Sunland Drive
- Park Boulevard & State Route 62
- Sullivan Road & El Sol Avenue (Knott's Sky Park)
- Yucca Trail & Airway Avenue
- Yucca Valley Town Hall & County Library

[This page is intentionally left blank]

**Safe Routes to School Focus Area****Community**

|  |                                   |
|--|-----------------------------------|
| Friendly Hills Elementary School                   | Joshua Tree                       |
| La Contenta Middle School & Black Rock High School | Yucca Valley (Town) / Joshua Tree |
| Landers Elementary School                          | Landers                           |
| Morongo Valley Elementary School                   | Morongo                           |
| Twentynine Palms High School                       | Twentynine Palms (City)           |
| Twentynine Palms Junior High School                | Twentynine Palms (City)           |
| Yucca Mesa Elementary School                       | Yucca Valley Area                 |

**Other Pedestrian & Bicycle Focus Area****Community**

|   |                         |
|---|-------------------------|
| Adobe Road & State Route 62                     | Twentynine Palms (City) |
| Baseline Road & Utah Trail                      | Twentynine Palms (City) |
| Copper Mountain College                         | Joshua Tree             |
| El Paseo Drive & Hillside Avenue                | Twentynine Palms (City) |
| Onaga Trail & Balsa Avenue                      | Yucca Valley (Town)     |
| Onaga Trail & Hopi Trail                        | Yucca Valley (Town)     |
| Onaga Trail & Sage Avenue                       | Yucca Valley (Town)     |
| Palm Avenue & Sunland Drive                     | Yucca Valley (Town)     |
| Park Boulevard & State Route 62                 | Joshua Tree             |
| State Route 62 & Avalon Avenue                  | Yucca Valley (Town)     |
| State Route 62 & Park Avenue                    | Morongo                 |
| State Route 62 & Warren Vista Drive             | Yucca Valley (Town)     |
| Sullivan Road & El Sol Avenue (Knotts Sky Park) | Twentynine Palms (City) |
| Yucca Trail & Airway Avenue                     | Yucca Valley (Town)     |
| Yucca Valley Town Hall & County Library         | Yucca Valley (Town)     |
| Morongo Valley Elementary School                | Morongo                 |
| Twentynine Palms High School                    | Twentynine Palms (City) |
| Twentynine Palms Junior High School             | Twentynine Palms (City) |
| Yucca Mesa Elementary School                    | Yucca Valley Area       |

# SAFE ROUTES TO SCHOOL FOCUS AREAS (B-6 TO B-31)

The first section of this appendix includes factsheets summarizing each school focus area; all four pages making up the individual school-specific plan. These four pages detail specific data, analysis, observations, photos, and recommendations for the identified school and surrounding community.

## PAGE 1

Provides an overview of the specific school focus area, detailed recommendations, and statistics.

**Friendly Hills Elementary School**  
LOCAL AREA PROJECT

Friendly Hills Elementary School is located at 732P Sunny Vista Road within the unincorporated area of Joshua Tree. While the school fronts Sunny Vista Road, a major intersection is formed with Alta Loma Drive. Both roadways are two-lane roadways that offer localized and regional access. The focus area is within half a mile of Highway 62 in the North, and less than a mile from Park Boulevard in the East. Low density residential housing surrounds the focus area, along with transit stops. Enhanced connections within the focus area are proposed within the "Detailed Recommendations" section to follow.

Community: Joshua Tree  
Total Cost: \$923,335

407 students enrolled  
52% students eligible for free or reduced lunch

**DETAILED RECOMMENDATIONS**

**Sunny Vista Rd. & Alta Vista Dr.**

- Repair existing school pavement marking that reads "SCHOOL" south of intersection.
- Install 150x48" raised island offset from curb face by 8' Western start point is at the crosswalk.
- Install stop sign for westbound approach west leg.
- Install ADA curb ramps at north and south corners of NE entrance to Friendly Hills Elementary School.
- Install ADA curb ramps at north and south corners of west entrance to Friendly Hills Elementary School.

**Sunny Vista Rd.**

- Install ADA curb ramp at NW corner of intersection.
- Install stop sign for eastbound approach west leg.
- Install westbound cycle track with green paint backing and green paint offset zone extending through school area (also west of crosswalk and 10' west of crosswalk).
- Eliminate existing school pavement markings that reads "SCHOOL, SCHOOL, SCHOOL" and replace with "SCHOOL" and "SCHOOL" at intersection with proper heading.
- Install STOP signs for both westbound and westbound Alta Loma Drive, creating two all-way stops at the Sunny Vista Road intersection. Install a raised island with westbound one-way cycle track on the north side of Alta Loma Drive between the two intersections. Extend westbound Class II bike lane to west end of school. Allow parallel parking along the north side of Alta Loma Drive west of the south leg of Sunny Vista Road.

**Alta Loma Dr.**

- Repair existing school pavement marking that reads "SCHOOL" at SW corner of Friendly Hills Elementary School.
- Upgrade flusher SR 4-1 to flush during school schedule only at SW corner of Friendly Hills Elementary School.
- Allow parallel parking along the north side of Alta Loma Drive west of the south leg of Sunny Vista Road. Provide a raised island with parking spaces against curb face starting from the western end of existing crosswalk.
- Repair existing school pavement marking that reads "SCHOOL" between Sunny Vista Rd and Juniper Rd.
- Upgrade flusher SR 4-1 to flush during school schedule only between Sunny Vista Rd. and Juniper Rd.

## PAGE 2

Provides a detailed visual map of where specific recommendations are located in proximity to key destinations, parks, and other local attractors within the school area.

**Friendly Hills Elementary School**  
ENGINEERING RECOMMENDATIONS MAP

## PAGE 3

Details walk safety assessment general comments and observations.

**Friendly Hills Elementary School**  
LOCAL AREA PROJECT

**WALK AUDIT GENERAL COMMENTS AND OBSERVATIONS**

**Sunny Vista Road**

- Roadway alignment is offset at the intersection with Alta Loma Drive.
- Large walking population present at this school - students are essential across the intersection with a school staff and/or crossing guard.

**Alta Loma Drive**

- Two-lane paved roadway providing East/West travel - this roadway becomes a challenge to travel on when the sun is rising and setting as the orientation of the road places the driver directly in the path of the sun.
- High vehicle speeds have been noted.
- Existing pedestrian school signage present and visible.
- Roadway condition is poor at times.

**Sunny Vista Road and Alta Loma Drive**

- Intersection at present is a composite of two multi-way stop controls; community residents note that drivers often do not stop at the stop controls.
- Drivers heading East are noted as being particularly challenging to control within the school area - often not stopping soon when children are in the crosswalk.
- Tourist traffic is re-routed along Alta Loma Drive increasing the number of vehicles who are unfamiliar with the area and traffic conditions - also increasing an alternative to Highway 62 when traffic is present.
- Existing pedestrian crosswalk present and slightly faded at West and South leg of the intersection.
- Community support is strong for intersection enhancements.

## PAGE 4

Existing conditions inventory photos.

**Friendly Hills Elementary School**  
EXISTING CONDITIONS

# OTHER PEDESTRIAN AND BICYCLE FOCUS AREAS (B-32 TO B-63)

The second section of this appendix includes factsheets summarizing the other (non-school) pedestrian and bicycle focus areas into two pages; making up the individual focus area plan. These two pages detail specific data, analysis, and recommendations for each of the identified focus area.

## PAGE 1

Provides an overview of the specific local (non-school) focus area, detailed recommendations, location, and total project cost.

**Palm Avenue & Sunland Drive**  
LOCAL AREA PROJECT

**Palm Avenue & Sunland Drive** provides access to a central area of Yucca Valley. The focus area is located north of Highway 10, a major East/West regional thoroughfare. Palm Avenue and Sunland Drive are local collector roads that connect to greater circulation networks. Two major recreation facilities are contained within the focus area. Popp Ranch Memorial Park and Brehm Park Family Recreation Center. A Boys and Girls Club is located centrally within the focus area and low density residential housing surrounds the focus area. Enhanced connections within the focus area are proposed within the "Detailed Recommendations" section to follow.

**Community:** Town of Yucca Valley  
**Total Cost:** \$4,117,498

**DETAILED RECOMMENDATIONS**

**Palm Ave.**

- Install 300' of 8' wide sidewalk south of Sunnyslope Dr. to park entrance on east side of road.
- Install ADA curb ramp at north and south corners of park entrance.
- Install 636' of 8' wide sidewalk to Sunland Dr on east side of road.
- Install 636' of 8' wide sidewalk from Sunland Dr. to Cassia Dr. on east side of road.
- Install 398' of 8' wide sidewalk from Cassia Dr. to Antelope Trail on east side of road.
- Install 277' of 8' wide sidewalk south of Antelope Trail on east side of road.

**Palm Ave. & Sunland Dr.**

- Install ADA curb ramps at north and south corners of intersection.
- Install regular white paint crosswalk from north to south.
- Install 253' of 8' wide sidewalk south to Sunland Dr. on south side of road.
- Install ADA curb ramps at north and south corners of southern intersection.

**Palm Ave. & Cassia Dr.**

- Install ADA curb ramps at NE and SE corners of intersection.

**Palm Ave. & Antelope Trail**

- Install ADA curb ramps at NE and SE corners of intersection.

**Sunland Dr.**

- Install ADA curb ramps at west and east corners of north parking lot entrance to Brehm Park Family Recreation Center.
- Install 608' of 8' wide sidewalk between north parking lot entrance and south parking entrance to Brehm Park Family Recreation Center on south side of road.
- Install ADA curb ramps at west and east corners of south parking lot entrance to Brehm Park Family Recreation Center.
- Install 154' of 8' wide sidewalk between south parking lot entrance to Brehm Park Family Recreation Center and field parking to entrance to the east on south side of road.
- Install ADA curb ramps at west and east corners of field parking lot.
- Install 111' and 608' of 8' wide sidewalk to Grand Ave on south side of road.
- Install 440' of 8' wide sidewalk from Grand Ave. to the west on north side of road.

**Sunland Dr. & Grand Ave.**

- Install ADA curb ramps at NW and SW corners of intersection.
- Install regular white paint crosswalk from north to south at west crossing.

**Sunnyslope Dr & Park Ave.**

- Install ADA curb ramp at SE corner of intersection.

## PAGE 2

Provides a detailed visual map of where specific recommendations are located in proximity to key destinations, parks, and other local attractors.

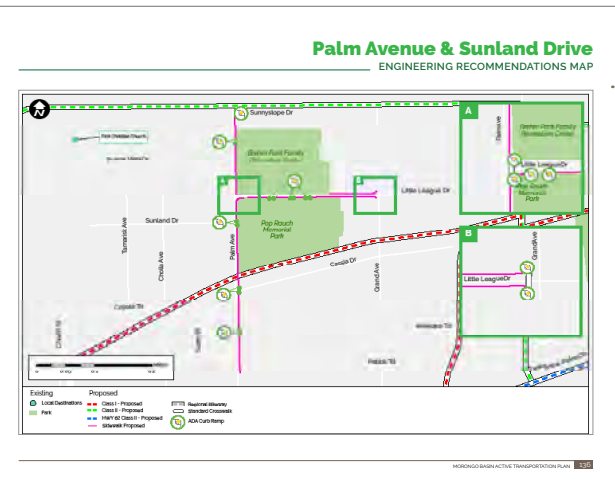

# Friendly Hills Elementary School

## LOCAL AREA PROJECT

**Friendly Hills Elementary School** is located at 7252 Sunny Vista Road within the unincorporated area of **Joshua Tree**. While the school fronts Sunny Vista Road, a major intersection is formed with Alta Loma Drive. Both roadways are two-lane roadways that offer localized and regional access. The focus area is within less than a mile of SR-62 in the north, and less than a mile from Park Boulevard in the east. Low density residential housing surrounds the focus area, along with transit stops.

**Community:** Joshua Tree

**Total Cost:** \$1,013,371



**407**

students enrolled



**52%**

students eligible for free & reduced-lunch

Source: 2017-18 California Longitudinal Pupil Achievement Data System (CALPADS)

### DETAILED RECOMMENDATIONS

#### Sunny Vista Road & Alta Vista Drive

- Repaint existing school pavement marking that reads, "SCHOOL" South of intersection.

#### Sunny Vista Road

- Install ADA curb ramps at North and South corners of NE entrance to school.
- Install ADA curb ramps at North and South corners of East entrance to school.

#### Sunny Vista Road & Alta Loma Drive

- Install high visibility school crosswalk from West to East at North leg of intersection.
- Install ADA curb ramp at NW corner of intersection.
- Install stop control for West leg.
- Install westbound cycle track with green paint backing and green paint conflict zone extend through school area (460' West of crosswalk and 150' East of crosswalk).
- Eliminate existing school pavement markings that reads, "SLOW SCHOOL XING" and repaint East of intersection with proper headway.
- Install STOP signs for both eastbound and westbound Alta Loma Drive, creating two all-way stops at the offset Sunny Vista Road approaches.
- Install a raised island with westbound one-way cycle track on the north side of Alta Loma Drive between the two intersections.
- Extend westbound Class II bike lane to West end of school. Allow parallel parking along the North side of Alta Loma Drive West of the South leg of Sunny Vista Road
- Install 160'x8' raised island offset from curb face by 8'. Western start point is at the crosswalk.

- Install stop sign for East leg.
- Install ADA curb ramp at NW and SW corner of west leg of intersection.
- Install 60'x8' raised island offset from curb face by 8'. Eastern start point is at the crosswalk.
- Repaint existing crosswalk with high visibility school crosswalk at West and South legs of the intersection.

#### Sunny Vista Road & Melton Trail

- Install high visibility white crosswalk for E/W crossing from SW to SE corners of intersection.
- Install new pedestrian W11-2 and W16-7P signage adjacent to crossing.
- Install new advanced yield pavement markings 20'-50' with R1-5 yield signage for north/south vehicle traffic.

#### Alta Loma Drive

- Repaint existing school pavement marking that reads, "SCHOOL" at SW corner of Friendly Hills Elementary School.
- Upgrade flasher SR 4-1 to flash during school schedule only on North side of roadway between Sunny Vista Road and Juniper Road
- Allow parallel parking along the north side of Alta Loma Drive west of the south leg of Sunny Vista Road Restripe and install 12 parallel parking spaces against curb face starting from the western end of existing sidewalk.
- Repaint existing school pavement marking that reads, "SCHOOL" between Sunny Vista Road and Juniper Road
- Upgrade flasher SR 4-1 to flash during school schedule only 60' W/O intersection with Sunny Vista Road

# Friendly Hills Elementary School

## ENGINEERING RECOMMENDATIONS MAP

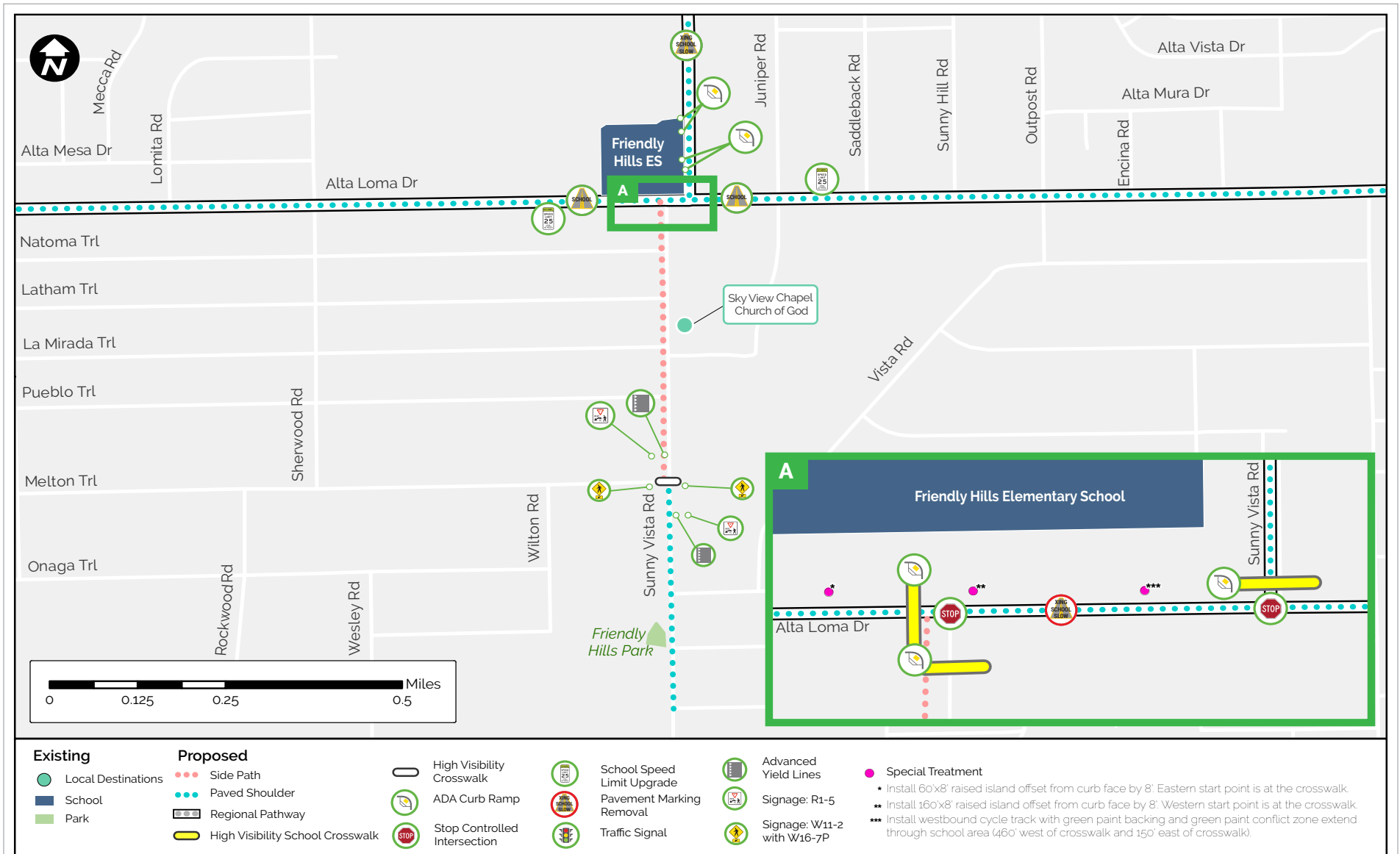



# Friendly Hills Elementary School

## LOCAL AREA PROJECT

### WALK AUDIT GENERAL COMMENTS AND OBSERVATIONS

#### Sunny Vista Road

- Large walking population present at this school – students are escorted across the west leg of the Sunny Vista Road and Alta Loma Drive intersection with a school staff and/or crossing guard

#### Alta Loma Drive

- Two lane paved roadway providing east/west travel – this roadway is a challenge to travel on when the sun rises and sets, depending on travel direction; the orientation of the Road places the driver directly in the path of the sun
- High vehicle speeds are typical within the school area
- Existing pedestrian school signage present and visible
- Roadway conditions are poor at times

#### Sunny Vista Road and Alta Loma Drive

- Intersection is a composite of two multi-way stop controls devices - alignment for the north/south Sunny Vista Road is staggered
- Drivers heading east are particularly challenging to control within the school zone – often not stopping regardless if children are in the crosswalk or not
- Tourist traffic has been re-routed along Alta Loma Drive increasing the number of visitors who are unfamiliar with the area and traffic controls
- Roadway is an alternative to SR-62 when heavy traffic is present
- Existing pedestrian crosswalk is present, but slightly faded at West and South legs of the intersection
- Community support is strong for intersection enhancements





# Friendly Hills Elementary School

EXISTING CONDITIONS



# La Contenta Middle & Black Rock High School

## LOCAL AREA PROJECT

**La Contenta Middle and Black Rock High School** are located adjacent to each other along La Contenta Road, a major two-lane N/S oriented roadway within **Yucca Valley**. Attractors that are proximal to the two schools include a bus transit center along Alta Loma Road/Yucca Trail and Indio Avenue as well as low density residential housing and undeveloped land. Major intersections that are within the bounds of the focus area include: Yucca Trail/La Contenta Road, SR-62 and La Contenta Road, and Yucca Trail and Indio Avenue

**Community:** Town of Yucca Valley

**Total Cost:** \$2,818,753

### La Contenta Middle School:



**749**

students enrolled

**70%**

students eligible for free & reduced-lunch

### Black Rock High School:



**122**

students enrolled

**75%**

students eligible for free & reduced-lunch

Source: 2017-18 California Longitudinal Pupil Achievement Data System (CALPADS)

## DETAILED RECOMMENDATIONS

### Indio Avenue & Yucca Trail

- Install 358' sidewalk in conjunction with proposed paved shoulder expansion of Yucca Trail between Hermosa Avenue and Indio Avenue on the South side of Road
- Install ADA curb ramp at NW, SW, and SE corner of intersection.
- Install RRFB sign for west and eastbound traffic at the NW and NE corners of the intersection.
- Install shark-tooth yield markings 20' west of crossing at SW corner of intersection.
- Install shark-tooth yield markings 60' East from crossing at NE corner of intersection.
- Install R 1-5 signs at SW and NE corners of intersection.
- Install side path from S/O Pueblo Trail Indio Avenue to Yucca Trail along the East side of the roadway.

### Yucca Trail

- Install 3,183' sidepath from Indio Avenue to La Contenta Road to SE corner of La Contenta Middle School.
- Install 675' sidewalk in conjunction with the paved shoulder expansion to the East of Indio Avenue on South side of Road

### Yucca Trail & La Contenta Road

- Install ADA curb ramp at NW corner of intersection.
- Widen roadway to install eastbound left turn lane.
- Install signalized intersection pending passing of signal warrant.

# La Contenta Middle & Black Rock High School

## ENGINEERING RECOMMENDATIONS MAP





# La Contenta Middle & Black Rock High School

## LOCAL AREA PROJECT

### WALK AUDIT GENERAL COMMENTS AND OBSERVATIONS

#### La Contenta Road

- Intersection with Yucca Trail has been host to pedestrian and vehicle collisions – strong community support is focused on providing remediation measures to better service existing conditions that might contribute to collisions; no traffic control device is present for east/west through traffic at the intersection with Yucca Trail
- Bus circulation within the school zone creates queueing within both sets of school driveways
- Lack of pedestrian sidewalks extending North towards Yucca Trail and South towards Black Rock High School and beyond – an existing body of students travel by foot and bike as their primary form of transportation to get to and from school
- Intersection with Sunnyslope Drive is host to drainage/flooding when adverse weather is present

#### Yucca Trail and Indio Avenue

- No traffic control device is present for east/west through traffic that supports N/S pedestrian crossing the intersection of Yucca Trail and Indio Avenue; walk audit participants noted this intersection is highly utilized by school population

#### Yucca Trail

- Overall lack of pedestrian infrastructure to support walking/biking student population who use this corridor and school area to travel to and from school (east/west travel)

#### Sunnyslope Drive

- Roadway is paved with existing sidewalk on South side of roadway
- Roadway is unpaved extending West past school zone – community supports connection opportunities that extend roadway West towards Avalon Avenue
- Lack of connectivity east/west from school sites – undeveloped land adjacent to school sites present.





# La Contenta Middle & Black Rock High School

EXISTING CONDITIONS



# Landers Elementary School

## LOCAL AREA PROJECT

**Landers Elementary School** is a located at 56450 Reche Road within the unincorporated area of **Landers**. Reche Road forms the major E/W roadway that bisects the focus area. The surrounding area is comprised of a rural desert landscape with low density residential housing proximal to the school. The focus area is 0.8 miles east of SR-247, which is the closest major regional thoroughfare.

**Community:** Landers

**Total Cost:** \$174,894



**166**

students enrolled



**88%**

students eligible for free & reduced-lunch

Source: 2017-18 California Longitudinal Pupil Achievement Data System (CALPADS)

## DETAILED RECOMMENDATIONS

### Reche Road

- Install speed feedback sign for eastbound traffic 660' West of Cambria Avenue on the south side of Road
- Repaint existing school pavement marking that reads "SCHOOL" between Cambria Avenue and Kristy Ln.
- Widen existing 6' sidewalk around existing utility poles and other barriers to meet ADA guidelines.
- Repaint existing school pavement marking that reads "SLOW SCHOOL XING" between Cambria Avenue and Kristy Ln.
- Repaint existing school pavement marking that reads "SLOW SCHOOL XING" between Fortuna Avenue and Cambria Avenue
- Repaint existing school pavement marking that reads "SCHOOL" between Fortuna Avenue and Cambria Avenue
- Install speed feedback sign for westbound traffic between Fortuna Avenue and Cambria

Avenue

### Reche Road & Cambria Avenue

- Repaint existing marked crosswalk with high visibility school crosswalk from north to south at west leg of intersection.
- Install shark's teeth yield line 30' West and 105' East of crosswalk.
- Repave intersection at NE corner. Consider implementation of drainage swales.
- Install R1-5 sign on SW corner of intersection and NE corner of intersection; both signs to be in line with proposed shark teeth yield lines.

# Landers Elementary School

## ENGINEERING RECOMMENDATIONS MAP





# Landers Elementary School

## LOCAL AREA PROJECT

### WALK AUDIT GENERAL COMMENTS AND OBSERVATIONS

#### Reche Road

- Lack of sidewalk along East and West extents of school zone
- Existing sidewalk is narrow and occasionally obstructed by utilities
- Vehicular speeds are high along corridor within school zone
- Dirt from shoulder washed out occasionally into roadway - flooding is common
- School advisory signs are present along route and in good condition
- Lack of paved shoulder for bicyclists to travel along
- Roadway section is 50' "curb-to-curb" within school area

#### Cambria Avenue

- Existing sidewalk is narrow and occasionally obstructed by utilities
- Vehicular traffic parks along both sides of the Road and pedestrians walk across roadway during school pick-up and drop-off

#### Reche Road and Cambria Avenue

- Intersection presents challenges for students and parents – visibility of crosswalk obstructed by washed out shoulder dirt
- NE corner is not paved and floods on occasion and dirt from missing paved area washes into intersections
- Existing school crosswalk is faded and lacks overall visibility



# Landers Elementary School

## EXISTING CONDITIONS





# Morongo Valley Elementary School

## LOCAL AREA PROJECT

### Morongo Valley Elementary School

is located at 10951 Hess Boulevard within the **Morongo Valley** area of San Bernardino County. The focus area is located within one mile of SR-62 a major four-lane regional E/W corridor. Localized connections are provided by Hess Boulevard a N/S collector, Juniper Avenue a N/S collector, Pioneer Drive an E/W collector, and Senilis Avenue an E/W collector. Low density residential housing is proximal to the focus area.

**Community:** Morongo Valley

**Total Cost:** \$1,206,277



**204**

students enrolled



**75%**

students eligible for free & reduced-lunch

Source: 2017-18 California Longitudinal Pupil Achievement Data System (CALPADS)

## DETAILED RECOMMENDATIONS

### Hess Boulevard

- Install proposed pedestrian sidepath from Pioneer Drive to Senilis Avenue on East side of Road
- Install ADA curb ramps at North and South corner of northern parking lot entrance to Morongo Valley Elementary School.
- Install ADA curb ramps at north and south corner of southern parking lot entrance to Morongo Valley Elementary School.
- Install solar powered speed feedback sign with SR 4-1 on the east side of the roadway, replacing existing R2-1, north of Mojave Drive

### Hess Boulevard & Mojave Drive

- Install ADA curb ramps at NE and SE corners of intersection.

### Hess Boulevard & Pioneer Drive

- Install ADA curb ramps at SW and SE corners of intersection.
- Install yield line with shark teeth yield line 70' west of 20' east of existing east leg crossing.
- Install R-15 sign to correspond to proposed yield line installation on SW and NE corners of intersection.
- Repaint existing high visibility crossing on south and east legs of the intersection.

### Knobb Avenue & Pioneer Drive

- Install ADA curb ramps at SW and SE corners of intersection.
- Install high visibility yellow crosswalk at south leg of the intersection.

### Mescalero Avenue & Pioneer Drive

- Install ADA curb ramps at SW and SE corners of intersection.
- Install high visibility yellow crosswalk at South leg of the intersection.

### Juniper Avenue & Pioneer Drive

- Install ADA curb ramps at SE corner of intersection.

### Pioneer Drive

- Install ADA curb ramps at West and East corner of sidewalk crossing at NE corner of Morongo Valley Elementary School property.

### San Jacinto Street & Pioneer Drive

- Install ADA curbs at SW and SE corners of intersection.

# Morongo Valley Elementary School

## ENGINEERING RECOMMENDATIONS MAP



# Morongo Valley Elementary School

## LOCAL AREA PROJECT

### WALK AUDIT GENERAL COMMENTS AND OBSERVATIONS

#### Hess Boulevard

- Roadway is narrow generally throughout the corridor – widening in the school area where school specific parking during pick-up and drop-off takes place
- Existing school signage and pavement markings exist in variable condition as observed during the walk audit
- Community desire for pedestrian and bicycle paths along corridor are strong, at present students and parents were found walking in the dirt area adjacent to the roadway; lack of pedestrian pathways along both sides of the corridor, immediately outside the school zone
- High vehicle speeds along corridor noted as a major concern with walk audit participants
- Residential land uses surround corridor and many pedestrians travel through the corridor that leads towards the school site - as observed during the walk audit and understood from participants
- Some pedestrians find traveling within the corridor challenging based on the fact that they are using strollers on dirt areas adjacent to the roadway

#### Pioneer Drive

- High quantity of pedestrian activity along corridor as they travel East and West away from the school site towards residential areas
- Some curb ramps are present but do not meet ADA requirements as observed during the walk audit
- Intersection with Hess Boulevard presents major crossing location for students and parents to travel to afterschool care facilities immediately to the north of the intersection





# Morongo Valley Elementary School

## EXISTING CONDITIONS



# Twentynine Palms High School

## LOCAL AREA PROJECT

**Twentynine Palms High School** is located at 72750 Wildcat Way, just west of Mesquite Springs Road, which provides access to SR-62. south of the campus in the **City of Twentynine Palms**. Surrounding the focus area is low density residential housing and undeveloped desert land. Major intersections that are proximal to the school site include Mesquite Springs Road and El Paseo Drive, Mesquite Springs Road and Sunnyslope Drive, Sunnyslope Drive and Larrea Avenue, and others.

**Community:** City of Twentynine Palms

**Total Cost: \$1,248,324**



**788**

students enrolled



**56%**

students eligible for free & reduced-lunch

Source: 2017-18 California Longitudinal Pupil Achievement Data System (CALPADS)

### DETAILED RECOMMENDATIONS

#### Sunnyslope Drive & Larrea Avenue

- Install all-way-stop pending passing of warrant.

#### Datura Avenue

- Install 436' sidewalk 8' wide from Sunnyslope Drive to Granite Avenue
- Install 3' wide sidewalk extension to existing 4' wide sidewalk for 560' from Granite Avenue to Wildcat Way on the east side of the roadway.
- Install ADA compliant driveways at NW entrance/exit of SW parking lot for Twentynine Palms High School.

#### Rose Ellen Avenue

- Install 3' wide sidewalk extension to existing 4' sidewalk for 880' on west side of the Road to Granite Avenue and on the north side of Granite Avenue to Datura Avenue
- Install 3' wide sidewalk extension to existing 4' sidewalk for 628' on east side of Road to end of Road

#### Granite Avenue

- Install 3' wide sidewalk extension to existing 4' sidewalk for 580' on south side of Road from Datura Avenue east to Rose Ellen Avenue to end of Road

#### Wildcat Way

- Install ADA compliant driveway at SE entrance of SW parking lot for Twentynine Palms High School.
- Install ADA compliant driveways at the South entrance and exit of SW access Road for Twentynine Palms High School.
- Install 3' sidewalk extension to existing 4'

sidewalk on the north side of the Road for 930'

#### El Paseo Drive & Mesquite Springs Road

- Install SW24-2 (CA) Assembly B sign at NW corner of intersection.
- Install SW24-2 (CA) Assembly B sign at SE corner of intersection.
- Install pedestrian hybrid beacon if it meets warrants at SW and SE corners of intersection.
- Install bulb out at SW and SE corners of intersection, extending east and west respectively.
- Install high visibility ladder style school crosswalk at the eastern and southern legs.
- Install SW24-3 (CA) Assembly D sign North of intersection.

#### Mesquite Springs Road & Wildcat Way

- Install high visibility school crosswalk to link existing pedestrian facility to proposed shared path at West leg of the intersection.

#### Mesquite Springs Road

- Install SW24-3 (CA) Assembly D signage North of El Paseo Drive
- Install SW24-3 (CA) Assembly D signage South of Wildcat Way.
- Install proposed pedestrian side path (Class I) from Wildcat Way south to SR-62.

#### Mesquite Springs Road & Sunnyslope Drive

- Install high visibility school crosswalk from at the West leg of the intersection.



# Twentynine Palms High School

## ENGINEERING RECOMMENDATIONS MAP



# Twentynine Palms High School

## LOCAL AREA PROJECT

### WALK AUDIT GENERAL COMMENTS AND OBSERVATIONS

#### Larrea Avenue and Sunnyslope Drive

- Intersection is large for pedestrian scale and uncontrolled for E/W pedestrian travel
- Intersection is noted to have poor visibility by walk audit participants as well as high vehicle speeds
- Intersection lacks infrastructure to support travel to and from school
- High quantity of pedestrians who are using this intersection to travel to residential housing towards the western sector of the school area

#### Mesquite Springs and El Paseo Drive

- Large walking population who utilizes this intersection to travel to and from school
- Intersection is uncontrolled for north/south traffic, however students cross at a crosswalk that links east/west from school site
- Visibility enhancements and control improvements desired by walk audit participants

#### Wildcat Way / Datura Avenue

- Sidewalks are narrow within school zone, they are utilized by bicycles and pedestrians throughout the morning and afternoon release periods
- Vehicles park along both sides of the roadway – some students noted cross Street to travel to vehicles and/or walk through dirt areas to get to roadways quicker

#### 2 Mile Road and Mesquite Springs Road

- Vehicles are noted to not stop for pedestrian traffic while crossing the intersection
- Intersection is void of pedestrian/bicycle infrastructure to support transportation through
- Existing multi-use path along Mesquite Springs Road is well utilized





# Twentynine Palms High School

EXISTING CONDITIONS



# Twentynine Palms Junior High School

## LOCAL AREA PROJECT

**Twentynine Palms Junior High School** is located at 5798 Utah Trail, at a major intersection between Utah Trail and Two Mile Road. Surrounding the school is Luckie Park, a major recreational facility attractor as well as Twentynine Palms Elementary School, peripheral residential housing uses, and undeveloped land in the **City of Twentynine Palms**.

**Community:** City of Twentynine Palms

**Total Cost: \$1,862,975**



**488**

students enrolled



**61%**

students eligible for free & reduced-lunch

Source: 2017-18 California Longitudinal Pupil Achievement Data System (CALPADS)

## DETAILED RECOMMENDATIONS

### Two Mile Road & Desert Knoll Avenue

- Install ADA curb ramp at SE corner of intersection.
- Install proposed sidepath from Adobe Road to Desert Knoll Avenue on North side of Road
- Install proposed sidepath from Aztec Avenue to Desert Knoll Avenue on South side of Road

### Two Mile Road

- Install proposed sidepath from Halsey Avenue to Luckie Avenue on North side of Road
- Install proposed sidepath from Wainwright Avenue to baseball field entrance on South side of Road
- Install SW24-3 (CA) Assembly D sign for eastbound traffic at baseball field entrance on south side of Road
- Install 673' of 10' wide sidewalk from Luckie Avenue to Utah Trail on North side of Road
- Repaint existing school pavement markings that read, "SLOW SCHOOL XING" between Luckie Avenue and Utah Trail
- Install SW24-3 (CA) Assembly D sign for westbound traffic between Luckie Avenue and Utah Trail
- Install proposed shared path from Utah Trail to dirt wash in the eastern sector of the focus area.

### Two Mile Road & Marine Avenue

- Install ADA curb ramps at all corners of intersection.
- Install SW24-3 (CA) Assembly D sign for westbound traffic on NW corner of intersection.
- Install SW24-2 (CA) Assembly B sign for eastbound traffic on SW corner of intersection.

### Two Mile Road & Halsey Avenue

- Install ADA curb ramps at SW and SE corners of intersection.
- Install speed feedback sign for eastbound traffic on SW corner of intersection.

### Two Mile Road & Wainwright Avenue

- Install ADA curb ramp at SW corner of intersection.

### Two Mile Road & Luckie Avenue

- Install ADA curb ramps at SW corner of intersection.
- Install bulb out at NE and SE corners, extending south and north respectively.

- Install SW24-2 (CA) Assembly B sign for westbound traffic at NE corner of intersection. Install SW24-2 (CA) Assembly B sign for eastbound traffic at SE corner of intersection.
- Install Assembly E (CA) R1-9 on mast arm at SE corner of intersection. Install Assembly E (CA) R1-9 on mast arm at NE corner of intersection.
- Install pedestrian hybrid beacon that includes pedestrian actuation at both ends of the crosswalk at this location, with warnings for eastbound and westbound traffic (NE and SE corners of intersection).
- Repaint existing school crosswalk with high visibility paint (ladder style) at East leg of intersection.

### Two Mile Road & Utah Trail

- Install bulb out at the NW, NE, and SW corners of the intersection with Two Mile Road and Utah Trail, extending south and north respectively. Allow drainage gap between bulb out and curb face 1' -2'.
- Install high visibility crosswalk west and north leg.

### Utah Trail & Crestview Drive

- Install SR4-1 (CA) Assembly C sign for northbound traffic North of intersection.

### Joe Davis Drive & Utah Trail

- Install high visibility crosswalk on west crossing with ADA curb ramps at NW and SW corners of intersection.

### Utah Trail

- Install SR4-1 (CA) Assembly C sign for northbound traffic North of Two Mile Road
- Repaint existing school pavement markings that reads, "SCHOOL" North of Two Mile Road
- Repaint existing school pavement markings that reads, "SCHOOL" on the SE corner of Morongo Unified School District.
- Repaint existing school pavement markings that reads, "SCHOOL" on the NE corner of Morongo Unified School District, south of Aztec Avenue
- Remove old signage; Install SR4-1 (CA) Assembly C sign for southbound traffic North of Aztec Avenue
- Repaint existing school pavement markings that reads, "SCHOOL" North of Aztec Avenue
- Repaint existing school pavement markings that reads, "SCHOOL" South of Joe Davis Drive

# Twentynine Palms Junior High School

## ENGINEERING RECOMMENDATIONS MAP

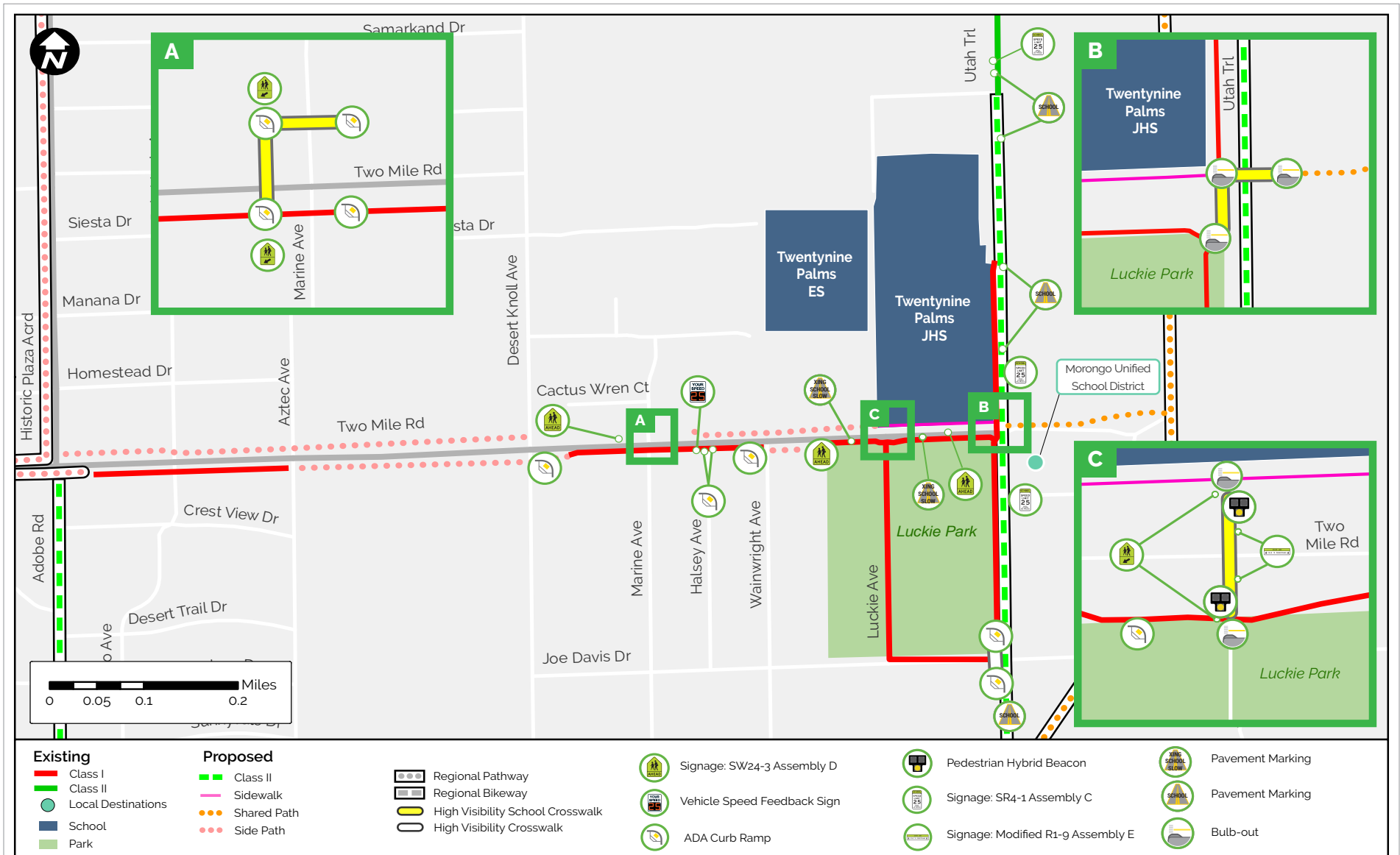



# Twentynine Palms Junior High School

## LOCAL AREA PROJECT

### WALK AUDIT GENERAL COMMENTS AND OBSERVATIONS

#### Two Mile Road

- Lack of pedestrian facilities on the North side of the roadway from Utah Trail in the East extending west towards Adobe Road
- Mid-block crossing at Luckie Avenue lacks control device for adequate pedestrian crossing and pedestrian visibility, but also provides access to area North of the crosswalk that does not support pedestrian travel
- High quantity of vehicular traffic and pedestrian/bicycle traffic within the focus area along this corridor
- Walk audit participants noted the overall lack of lighting on paths within focus area

#### Utah Trail

- Bus and vehicular traffic present in relatively large quantities throughout the school area along the corridor
- Pedestrian/bicycle path exists on West side of the roadway within the school area, which is well utilized by students but is too narrow to accommodate larger quantities of non-motorized traffic
- Through general observations and during the walk audit it was noted that vehicles park along both sides of the roadway and block the existing sidepath
- Walk audit participants noted the overall lack of lighting along corridor

#### Two Mile Road and Utah Trail

- Intersection is controlled by all-way stop control device, allowing enhanced crossing control
- Large quantity of students have been noted during the walk audit to cross along the West leg to travel to residential housing extending South and West from the intersection



# Twentynine Palms Junior High School

EXISTING CONDITIONS





# Yucca Mesa Elementary School

## LOCAL AREA PROJECT

**Yucca Mesa Elementary School** is located at 3380 Avalon Avenue within the peripheral areas of **Yucca Valley**. While the school fronts Avalon Avenue a N/S corridor, Aberdeen Drive is just north of the campus and forms the closest major E/W corridor; both are two-lane roadways. The focus area is surrounding by low density residential housing within a rural desert landscape.

**Community:** Town of Yucca Valley

**Total Cost:** \$551,081



**422**

students enrolled



**70%**

students eligible for free & reduced-lunch

Source: 2017-18 California Longitudinal Pupil Achievement Data System (CALPADS)

## DETAILED RECOMMENDATIONS

### Aberdeen Drive & Avalon Avenue

- Install high visibility school crosswalk at all crossing of intersection.
- Install ADA curb ramp at SW corner of intersection.

### Avalon Avenue

- Install 370' long shared path (12' wide) from Aberdeen Drive to school property.
- Repaint existing school pavement marking that reads "SCHOOL" between Aberdeen Drive and Yucca Mesa Elementary School.
- Replace existing (S4-3P, R2-1, S4-2) sign assemblies with a solar power speed feedback sign and a SR4-1 Assembly C for southbound traffic 150' S/O Aberdeen Drive and for northbound traffic 560' N/O Del Mar Street
- Repaint existing school pavement marking that reads "SLOW SCHOOL XING" at NE corner of Yucca Mesa Elementary School.
- Ensure operation of school area flashers is on a time-of-day schedule, flashing during school hours only at S/O northern school driveway.
- Install advanced yield line 20' North of east/west school crossing in front of Yucca Mesa Elementary School.
- Install ADA curb ramp at west corner of east/west school crossing in front of Yucca Mesa Elementary School.
- Install painted curb extension/no parking area that extends 8' east from curb face at west end of school crossing in front of Yucca Mesa Elementary School.
- Install advanced yield line 20' south of east/west school crossing in front of Yucca Mesa

Elementary School.

- Install 330' sidewalk on the West side of Road from North driveway to South driveway.
- Install ADA curb ramps at North and South corners of SE driveway into Yucca Mesa Elementary School.
- Repaint existing school pavement marking that reads "SLOW SCHOOL XING" South school crosswalk.
- Install 990' in length and 12' wide shared path (asphalt) along West side of Road from school property to Del Mar Street

### Avalon Avenue & Drexel Road

- Repaint existing school pavement marking that reads "SCHOOL" at NE corner of intersection.
- Replace existing SR4-1 sign with solar power speed feedback sign at NE corner of intersection.

### Avalon Avenue & Del Mar Street

- Install ADA curb ramp at NW corner of intersection.

# Yucca Mesa Elementary School

## ENGINEERING RECOMMENDATIONS MAP

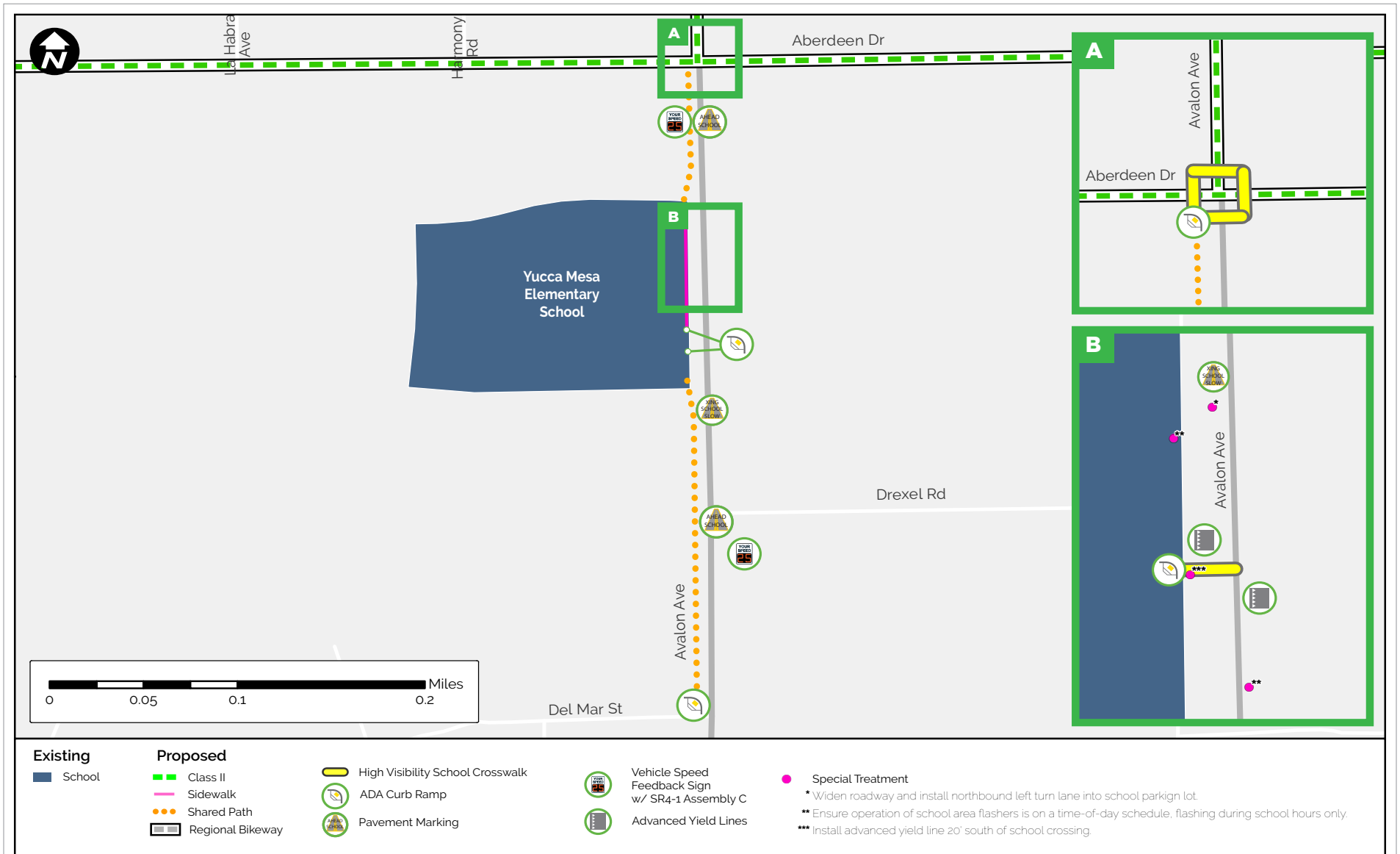

# Yucca Mesa Elementary School

## LOCAL AREA PROJECT

### WALK AUDIT GENERAL COMMENTS AND OBSERVATIONS

#### Avalon Avenue

- Missing sidewalk/pedestrian path extending North and South of the school campus on both sides of the corridor where non-motorized traffic travel
- Pedestrian crossing in front of school lacks ADA curb ramp on West end; no pedestrian facilities are present at the East end of the crossing (i.e. lack of sidewalk, paved shoulder, etc.)
- Vehicular traffic was observed to park on both sides of the corridor within the school zone - pedestrians cross outside of the marked crosswalk
- Existing signage is visible; existing mast arm flashing beacons need to be refurbished
- Existing pedestrian crossing lacks visibility and is faded
- Roadway width in front of school zone is 44' curb to edge of pavement
- School bus stations are unsupported by pedestrian infrastructure
- Stray dogs have been present within school vicinity - as noted by the walk audit participants
- Most significant walking population pulls from the southern area of the school zone

#### Aberdeen Drive

- Lack of pedestrian and/or bicycle facilities within school area on both sides of corridor
- Intersection with Avalon Avenue forms an all-way stop; existing crosswalks are visible, but have been noted by walk audit participants to fade over time
- Drainage/flooding concerns frequent within area

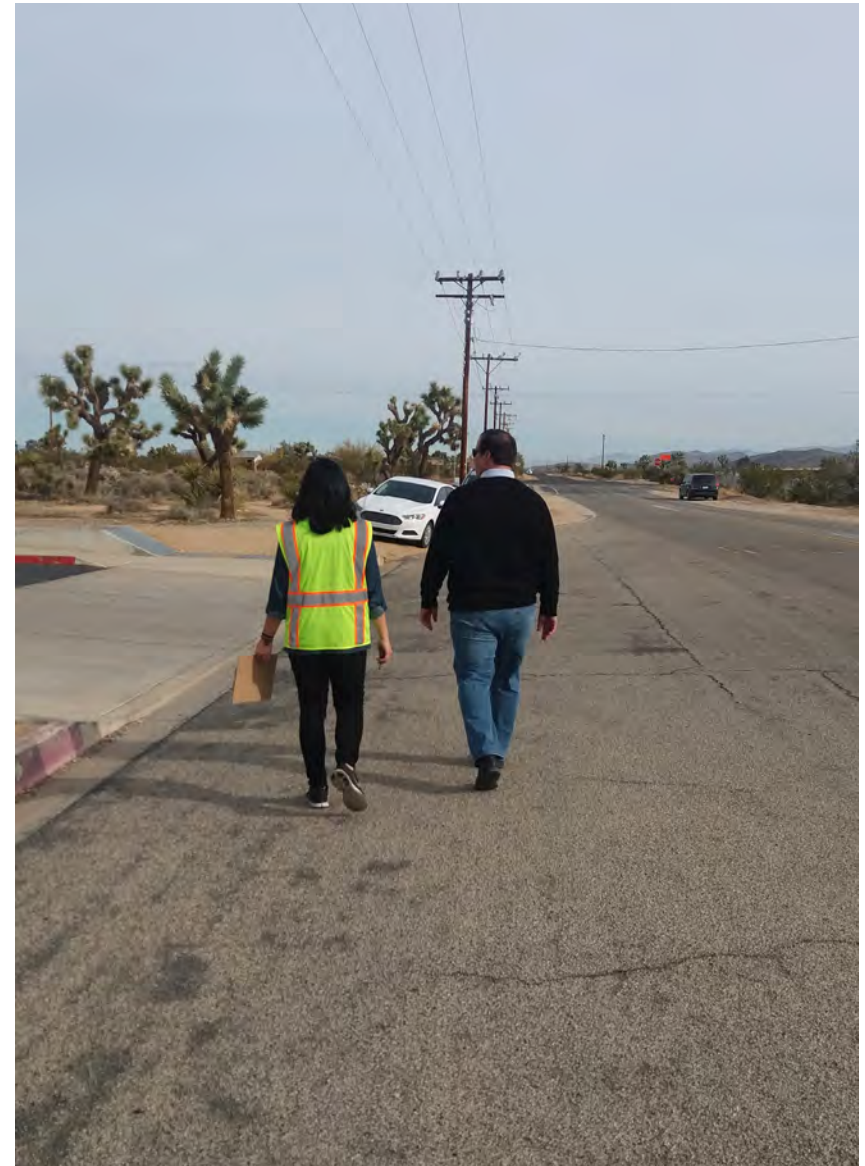



# Yucca Mesa Elementary School

EXISTING CONDITIONS



# Adobe Road & State Route 62

## LOCAL AREA PROJECT

**Adobe Road and SR-62** is a local focus area that is at the crux of Downtown **Twentynine Palms**, the City's major commercial corridor intersection. Adobe Road is a multi-lane corridor that provides N/S connections throughout the City. SR-62 is a multi-lane corridor that connects across the region. Local destinations within the focus area include: food conveniences, religious institutions, the Twentynine Palms Senior Center, the Twentynine Palms Transit Center, and the Eastern access to Joshua Tree National Park (National Park Drive). Residential housing surrounds the focus area.

**Community:** City of Twentynine Palms

**Total Cost:** \$730,779

### DETAILED RECOMMENDATIONS

#### SR-62

- Install 550' of sidewalk from Adobe Road to Palo Verde Avenue on south side of highway.
- Repaint existing pavement marking, "PED XING" between Tamarisk Avenue and Desert Queen Avenue
- Repaint existing pavement marking, "PED XING" between Tamarisk Avenue and Yucca Avenue
- Install transit facility stop enhancements between Yucca Avenue & Smoketree Avenue on North side of the roadway.
- Install ADA compliant driveway at entrance to the commercial property at the SE corner of the intersection with Adobe Road

#### SR-62 & Tamarisk Avenue

- Install ADA curb ramps at the NE and SE corner of the intersection.
- Install W 11-2 signage at NW corner facing East and SW corner facing West.
- Install pedestrian hybrid beacon with mast arm at NW and SW corners of intersection for eastbound and westbound traffic.
- Install bulb out that extend to existing shoulder line at NW and SW corners of intersection.
- Install transit facility enhancements at SW corner of intersection just E/O crosswalk.

#### SR-62 & Yucca Avenue

- Install ADA curb ramps at all corners.

#### SR-62 & Smoketree Avenue

- Install ADA curb ramps at all corners.

#### SR-62 & Cholla Avenue

- Install ADA curb ramps at all corners.

#### SR-62 & Adobe Road

- Install ADA curb ramps at all corners.
- Repaint white paint crosswalks at all legs with high

visibility paint.

#### SR-62 & Ocotillo Avenue

- Install ADA curb ramps at NW and NE corners.
- Install ADA compliant driveway into shopping center at South end of intersection.

#### Cactus Road

- Install proposed Class II bike lane from Adobe Road to National Park Drive
- Install proposed Class III bike route from Adobe Road to Split Rock Avenue to Adobe Road

#### Adobe Road & Joshua Drive

- Install transit stop enhancements at NW corner.

#### Adobe Road & Cactus Drive (South)

- Install high visibility white crosswalk for crossing across Adobe Road from SW to SE corner of intersection with Cactus Drive South.
- Install new W11-2 with W16-7P signage on each side of new crossing.
- Install new advanced yield lines 20'-50' prior to crossing along with new R1-5 yield signs

#### Adobe Road & Cactus Drive (North)

- Install high visibility white crosswalk for crossing across Adobe Road from NW to NE corner of intersection with Cactus Drive North..
- Install new W11-2 with W16-7P on each side of new crossing.
- Install new advanced yield lines 20'-50' prior to crossing along with new R1-5 yield signs.

#### Cactus Drive (North) & National Park Drive

- Install high visibility white crosswalk for crossing across National Park Drive
- Install new W11-2 with W16-7P on each side of new crossing.
- Install new advanced yield lines 20'-50' prior to crossing along with new R1-5 yield signs.

# Adobe Road & State Route 62

## ENGINEERING RECOMMENDATIONS MAP

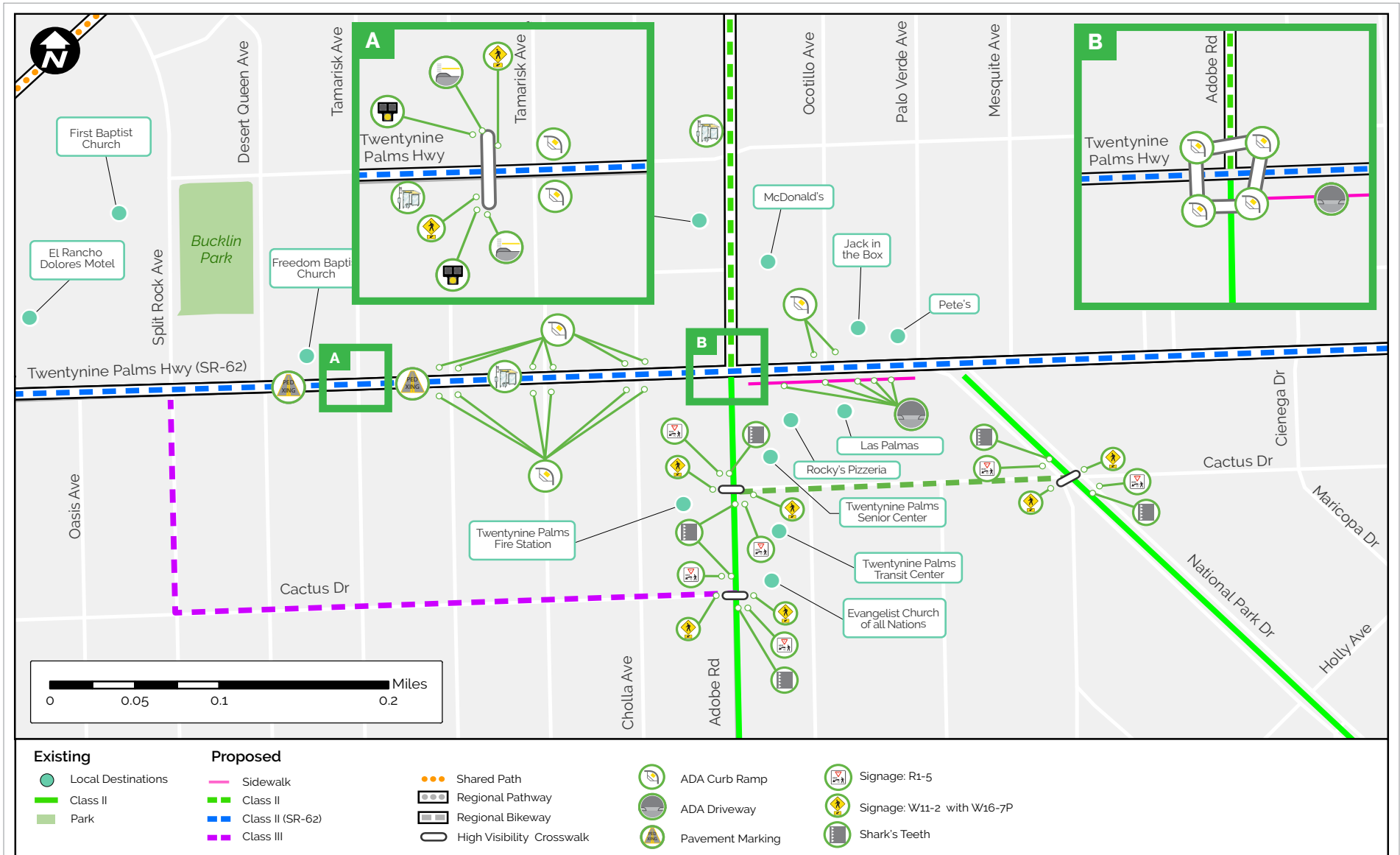

# Baseline Road & Utah Trail

## LOCAL AREA PROJECT

---

**Baseline Road and Utah Trail** is a focus area within the Eastern sector of **Twentynine Palms**. Baseline Road forms the major E/W connector through the area, while Utah Trail forms the major N/S connector. Utah Trail connects from SR-62 in the South into Joshua Tree National Park. Palm Vista Elementary School is contained within the focus area as well as rural residential housing land uses towards the eastern sector of the focus area. Undeveloped land comprises all other areas of the focus area.

**Community:** City of Twentynine Palms

**Total Cost:** \$910,221

### DETAILED RECOMMENDATIONS

#### Baseline Road

- Install proposed pedestrian sidepath from SE Palm Vista Elementary School entrance to Bedouin Avenue on the North side and South side of the roadway respectively.

#### Baseline Road & Utah Trail

- Install ADA curb ramps at NE and SE corners of intersection.
- Install Assembly B replacing existing signage at NW and NE corners of intersection.
- Install Assembly E (CA) R1-9 on mast arm replacing existing signage at NW and NE corners of intersection.
- Install pedestrian hybrid beacon mast arm with pedestrian activation; pending meets MUTCD warrants at NW and NE corners of intersection.
- Install transit facility enhancements at NE corner of intersection.



# Baseline Road & Utah Trail

## ENGINEERING RECOMMENDATIONS MAP

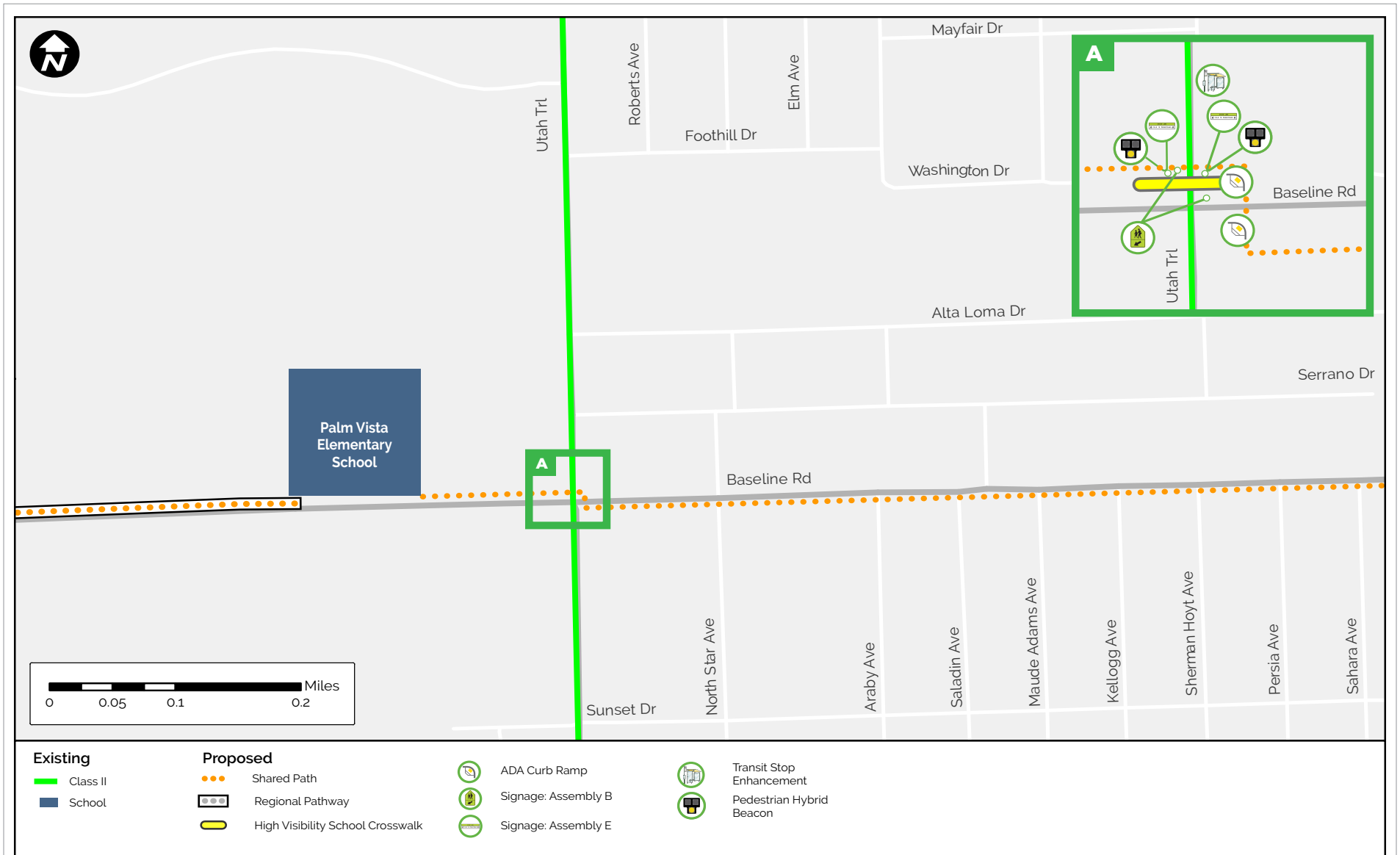

# Copper Mountain College

## LOCAL AREA PROJECT

---

**Copper Mountain College** is a focus area located within **Joshua Tree**, just west of Twentynine Palms, which is proximal to SR-62 a major E/W corridor that provides connections to regions in either direction from the focus area's centroid. Rotary Way provides N/S linkages to SR-62. Copper Mountain College is an education higher educational facility that services the region as a whole, connection that link to and from this local attractor are provided by the noted circulation network.

**Community:** Joshua Tree

**Total Cost:** \$301,447

### DETAILED RECOMMENDATIONS

#### Rotay Way

- Install proposed paved shoulder path from Gianneli Road south towards SR-62 on both sides of the roadway.

# Copper Mountain College

## ENGINEERING RECOMMENDATIONS MAP

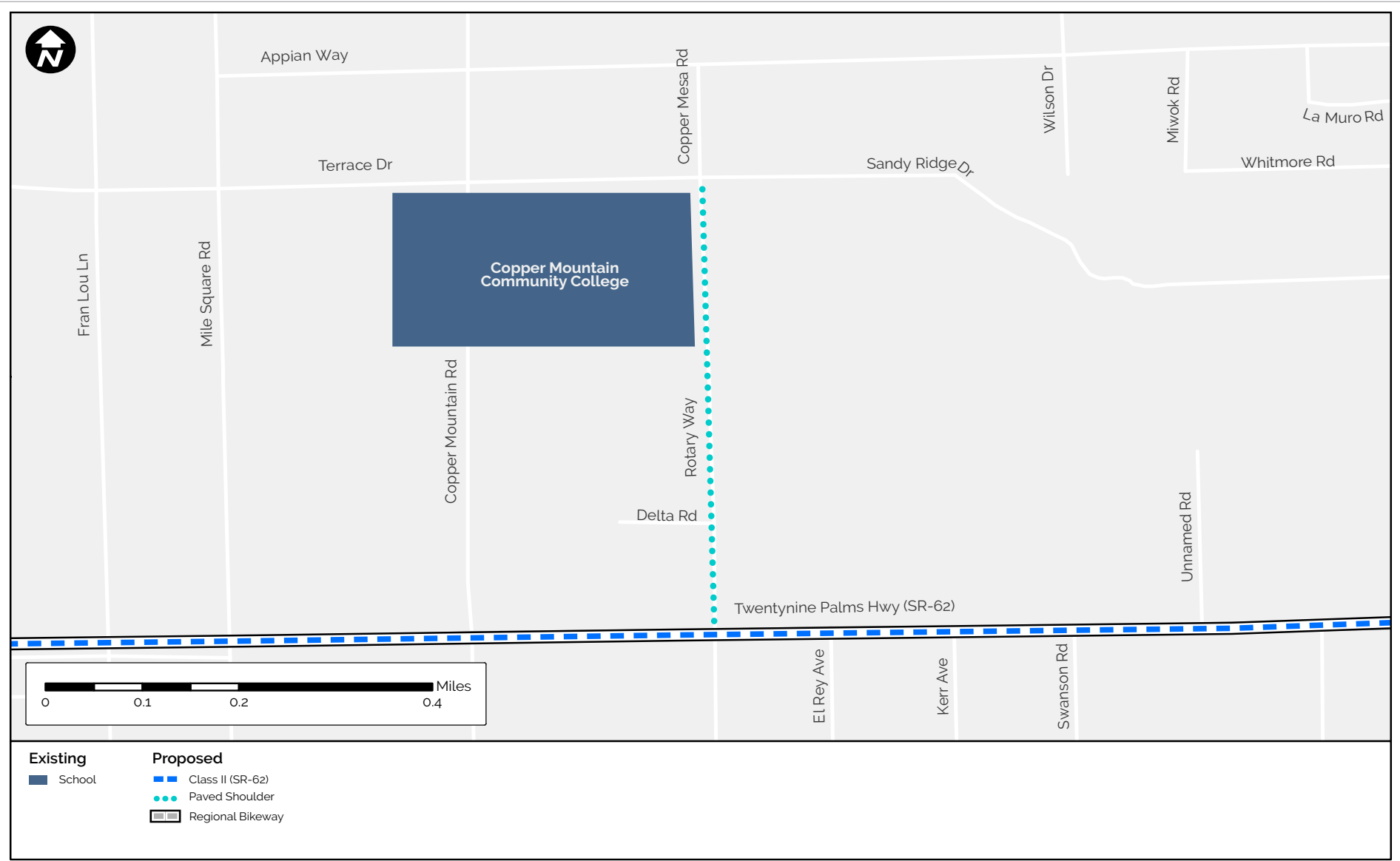



# El Paseo Drive & Hillside Avenue

## LOCAL AREA PROJECT

**El Paseo Drive and Hillside Avenue** is a focus area at the crux of two arterial roadways that both service two lanes of travel each way within the **City of Twentynine Palms** (north-western sector). The center of the focus area is less than one mile North of SR-62, a major regional corridor, and West of the Twentynine Palms Municipal amenities, including Veteran's Park. These amenities are adjacent to Adobe Road a commercial corridor that runs N/S. Oasis Elementary School fronts El Paseo Drive, and Twentynine Palms High School is proximal to the intersection of Mesquite Springs and El Paseo Drive

**Community:** City of Twentynine Palms

**Total Cost:** \$2,236,852

### DETAILED RECOMMENDATIONS

#### El Paseo Drive

- Install 2,129' of 6' wide sidewalk from Mesquite Springs Road to Hillside Avenue on the North side of Road
- Install proposed Class II bike lane from Mesquite Springs Road to Yucca Avenue
- Repaint existing pavement marking, "SCHOOL" 70' E/O the intersection with Mesquite Springs Drive
- Install 760' of 6' wide sidewalk East of Hillside Avenue on North side of Road
- Install 474' of 8' wide sidewalk west of Oasis Avenue on north side of Road
- Install side path (Class I) from Yucca Avenue to Bagley Avenue

#### El Paseo Drive & Split Rock Avenue

- Install bulb at all corners of intersection, converting from existing curb ramps at SW and NE corners.
- Repaint existing pavement marking, "SCHOOL" east and west of intersection.
- Install high visibility ladder style school crosswalk at all legs of the intersection.

#### El Paseo Drive & Yucca Avenue

- Eliminate existing mid-block crossing, existing signage, and school pavement markings on eastbound and westbound approaches.
- Eliminate existing side path on north side of El Paseo -100' in each direction of the intersection of Yucca Avenue for Class II installation.

#### El Paseo Drive & Bagley Avenue

- Install W11-2 with W16-7P signage at NW, SW,

and NE corners of intersection.

- Install R 1-5 signage at SW corner of intersection.
- Install full bulb out at the NW corner and a bulb out at the SW corner that extends north.
- Convert existing curb ramp at the NE corner into a bulb out that extends west.
- Install shark's teeth yield line 80' prior to crosswalk proposed at NE corner of intersection.
- Install shark's teeth yield line 20' prior to crosswalk proposed at SW corner of intersection.
- Eliminate side path, widen roadway and install Class II Bike Lane one way west of intersection.
- Install pavement markings that read, "SLOW CROSSING AHEAD" 100' prior to yield line west of intersection.
- Install pavement markings that read, "SLOW CROSSING AHEAD" 100' prior to yield line east of intersection.
- Repaint existing yellow paint crosswalk with white paint at north and west crossings of intersection.

#### Smoketree Avenue / Civic Center Drive

- Install 639' of 8' wide sidewalk on the East and North side of the "L" shaped roadway.

# El Paseo Drive & Hillside Avenue

## ENGINEERING RECOMMENDATIONS MAP

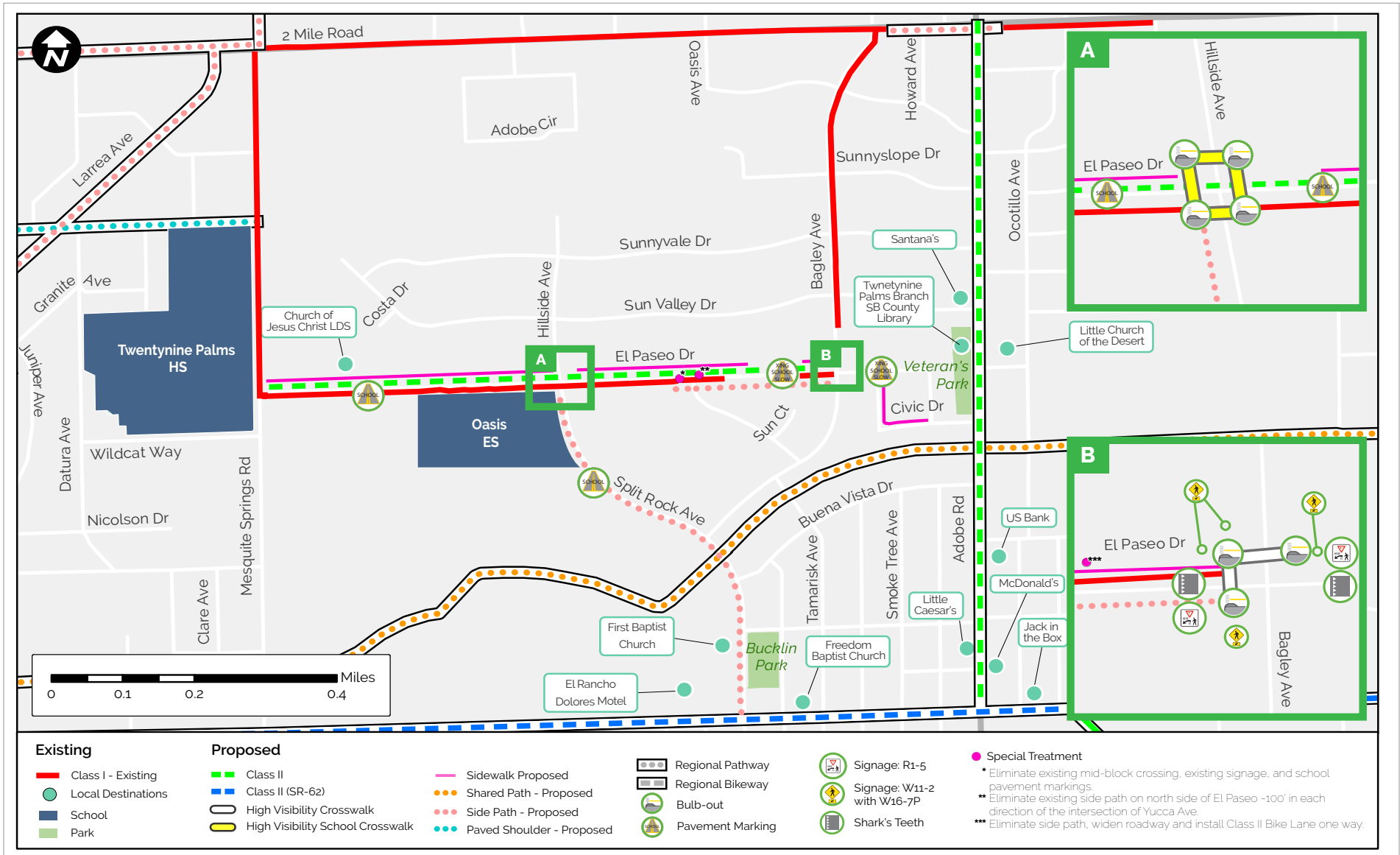

# Onaga Trail & Balsa Avenue

## LOCAL AREA PROJECT

**Onaga Trail and Balsa Avenue** is a focus area located within the south-central sector of the **Town of Yucca Valley**. Major cross streets are Onaga Trail, a two-lane E/W arterial roadway, and Balsa Avenue, a N/S oriented collector roadway. Contained within the focus area are Onaga Elementary School, transit facilities, religious institutions, and peripheral residential housing land uses – to which connections are made between regional and local attractors.

**Community:** Town of Yucca Valley

**Total Cost:** \$2,669,973

### DETAILED RECOMMENDATIONS

#### Pueblo Trail & Alaba Avenue

- Install ADA curb ramps at SW and SE corners.
- Repaint existing crosswalk at all crossings of intersection.
- Install all-way stop if the intersection meets warrants for an all-way stop per MUTCD 2B.07 paragraph 05 D.

#### Alaba Avenue

- Install 1,266' of 8' wide sidewalk south of Pueblo Trail to Onaga Trail on both sides of Road

#### Onaga Trail & Hilton Avenue

- Repaint existing sidewalk with high visibility school crosswalk at North crossing.

#### Onaga Trail & Victoria Avenue

- Repaint existing crosswalk with high visibility school crosswalk at North crossing.
- Make enhancements to transit stop at SW corner
- Repaint existing school pavement marking that reads "SCHOOL" at SE corner of intersection.

#### Onaga Trail & Alaba Avenue

- Install bulb out at NW, NE, and SE corner of the intersection. SE bulb out should extend north, while NW and NE bulb outs should be full, extending outward in direction of curb radius. Allow drainage gap between bulb out and curb face of 1'-2'.
- Repaint existing crosswalk with high visibility school crosswalk at all crossings of intersection.
- Install signal pending passing of signal warrant.

#### Onaga Trail & Frontera Avenue

- Repaint existing crosswalk with high visibility school crosswalk at North and South crossings.

#### Onaga Trail & Balsa Avenue

- Install ADA curb ramps at all corners of intersection.
- Repaint existing school pavement marking that reads "SCHOOL" from Balsa Avenue to Frontera Avenue

#### Onaga Trail & Emerson Avenue

- Install ADA curb ramps at NW and NE corners of intersection.

#### Onaga Trail

- Install 365' of 8' wide sidewalk between Balsa Avenue and Emerson Avenue on North side of Road
- Install 384' of 8' wide sidewalk between Emerson Avenue and Hanford Avenue on North side of Road
- Install sidewalk in conjunction with paved shoulder recommendation between Balsa Avenue and Hanford Avenue on South side of Road

#### Onaga Trail & Hanford Avenue

- Install ADA curb ramps at all corners of intersection.

#### Balsa Avenue

- Install 308' of 8' wide sidewalk from Onaga Trail to Taos Trail on East side of Road
- Install 1,417' of 8' wide sidewalk from Onaga Trail to end of pavement on West side of Road
- Install 313' of 8' wide sidewalk between Taos Trail and Navajo Trail on East side of Road
- Install 509' of 8' wide sidewalk between Navajo Trail and Mountain View Trail

#### Balsa Avenue & Taos Trail

- Install ADA curb ramps at NE and SE corners of intersection.

#### Balsa Avenue & Navajo Trail

- Install ADA curb ramps at NE and SE corners of intersection.

#### Balsa Avenue & Mountain View Trail

- Install ADA curb ramp at NE corner of intersection.



# Onaga Trail & Balsa Avenue

## ENGINEERING RECOMMENDATIONS MAP

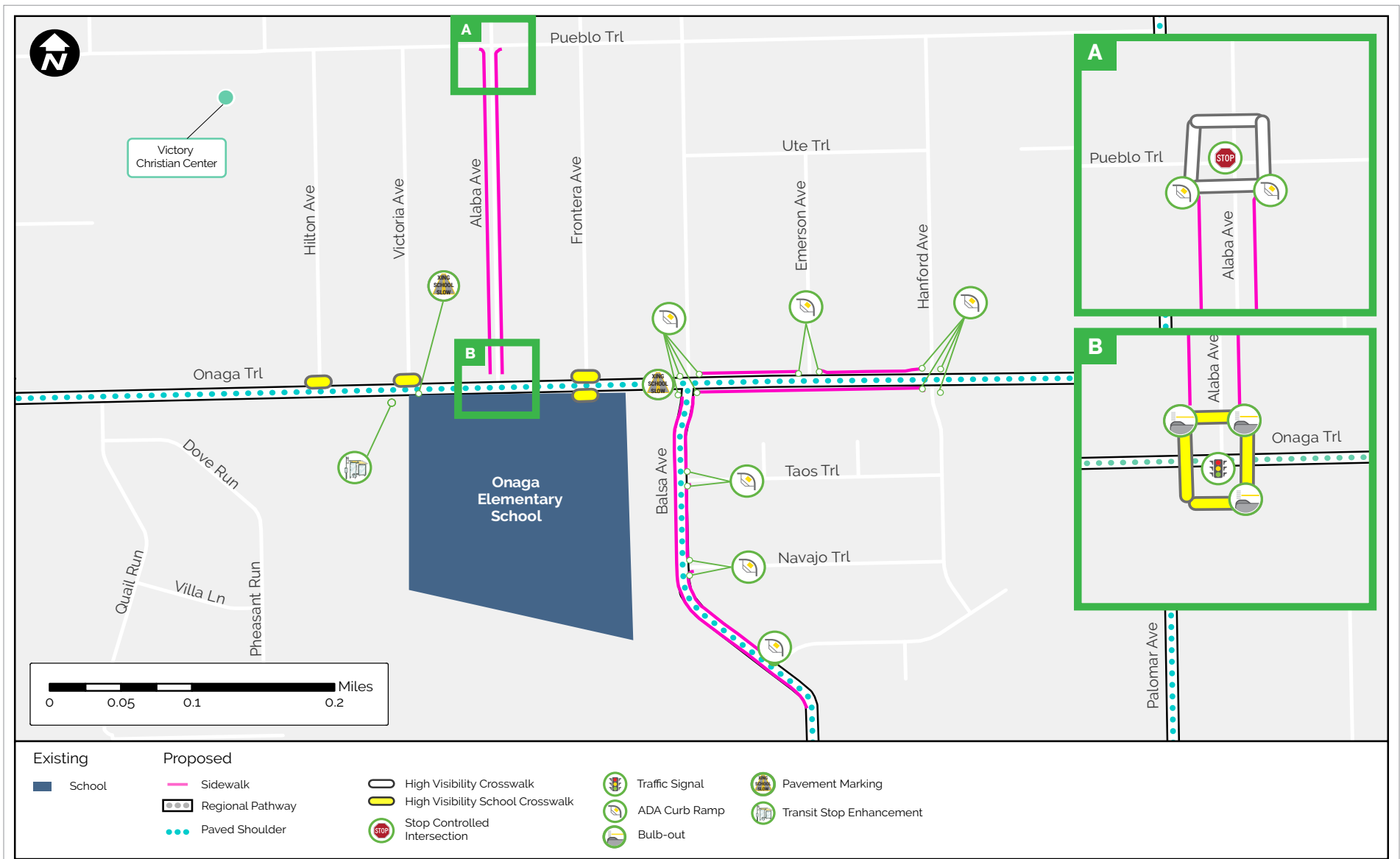

# Onaga Trail & Hopi Trail

## LOCAL AREA PROJECT

### DETAILED RECOMMENDATIONS

#### Onaga Trail and Hopi Trail

provides connections to the western area of **Yucca Valley**, which is just south of SR-62 – the regional E/W major thoroughfare. Local connections are provided along Onaga Trail a two-lane E/W roadway and Hopi Trail a two-lane N/S collector roadway. Contained within the focus area are attractors that include: Yucca Valley Elementary School, Jacobs Park/recreational facility, religious institutions, and residential housing land uses.

**Community:** Town of Yucca Valley

**Total Cost:** \$2,251,902

#### Santa Fe Trail & Inca Trail

- Install ADA curb ramps at NE and SE corners of intersection.
- Install 307' of 8' wide sidewalk north of intersection to SR-62 on east side of Road

#### Inca Trail & Pueblo Trail

- Install ADA curb ramps at NE and SE corners of intersection.
- Install 208' of 8' wide sidewalk North of intersection to Santa Fe Trail on East side of Road

#### Mariposa Trail & Pueblo Trail

- Install ADA curb ramps at SW and SW corners of intersection.
- Repaint existing school pavement markings that read "SCHOOL" to the west of intersection.
- Install 283' of 8' wide sidewalk extending West of intersection towards Inca Trail on south side of Road

#### Hopi Trail & Pueblo Trail

- Install ADA curb ramps at the NE and NW corners.
- Install bulb out at the SE and SW corner, extending west and east respectively.
- Repaint existing school pavement marking that reads "SCHOOL" to the south of intersection.
- Install 299' of 8' wide sidewalk to the west of intersection to Mariposa Trail on South side of Road
- Repaint existing crosswalk with high visibility school crossing at west, south, and east crossings of the intersection.
- Install new high visibility school crosswalk at north leg.

#### Geronimo Trail & Pueblo Trail

- Repaint existing school pavement marking that reads "SCHOOL" to the south of intersection.
- Install 804' of 8' wide sidewalk to the west of intersection to Hopi Trail and east to Fox Trail on South side of Road

#### Hopi Trail

- Widen sidewalk by 4' for 151' south of Pueblo Trail Widen sidewalk by 4' for 236' to the West of Yucca Valley Elementary School on East side of Road
- Install 4' sidewalk extension for 470' north of Onaga Trail on East side of Road
- Install 883' of 8' wide sidewalk from Onaga Trail to Navajo Trail to Mariposa Trail on West side of Road to North side of Navajo Trail
- Repaint existing school pavement marking that reads "SCHOOL" to the North of Onaga Trail
- Repaint existing school pavement marking that reads "SCHOOL" to the South of Onaga Trail and North of Navajo Trail

#### Onaga Trail

- Expand roadway from 26' to ~50' to accommodate for 8' paved shoulder while maintaining 13' vehicle travel lanes.
- Install truncated domes West and East of entrances to Hi Desert

Park between Hopi Trail & Fox Trail

- Install ADA compliant driveway at unnamed Road between Hopi Trail & Fox Trail
- Repaint existing school pavement marking that reads "SCHOOL" to the west of Fox Trail
- Install 361' of 8' wide sidewalk between Hopi Trail and Geronimo Trail and 361' of 8' wide sidewalk between Geronimo Trail and Fox Trail

#### Onaga Trail & Shawnee Trail

- Install ADA curb ramp at SE corner of intersection.

#### Onaga Trail & Inca Trail

- Install ADA curb ramp at SW and SE corners of intersection.
- Install 274' of 8' wide sidewalk to the west of intersection to Shawnee Trail on South side of Road

#### Onaga Trail & Mariposa Trail

- Install ADA curb ramp at SW and SE corners of intersection.
- Install 275' of 8' wide sidewalk to the West of intersection to Inca Trail on South side of Road
- Repaint existing school pavement marking that reads "SCHOOL" to the East of intersection.

#### Onaga Trail & Hopi Trail

- Install full bulb out at the NE and SE corner. Install half bulb out into Hopi Trail on the NW and SW corners, extending south and north respectively.
- Install 271' of 8' wide sidewalk to the West of intersection to Mariposa Trail on south side of Road
- Repaint existing crosswalk with high visibility school crossing at North, South, and East crossings of intersection.

#### Onaga Trail & Elk Trail

- Install ADA curb ramp at NW and NE corners of intersection.
- Install 385' of 8' wide sidewalk to the West intersection to Fox Trail on South side of Road

#### Onaga Trail & Deer Trail

- Install ADA curb ramp at NW corner of intersection.
- Install 415' of 8' wide sidewalk to the West of intersection to Elk Trail on South side of Road

#### Navajo Trail & Inca Trail

- Install ADA curb ramp at NE corner of intersection.

#### Navajo Trail & Mariposa Trail

- Install ADA curb ramp at NW and NE corners of intersection.
- Install 301' of 8' wide sidewalk to the West of intersection to Inca Trail on North side of Road

#### Navajo Trail & Inca Trail

- Install ADA curb ramp at NW corner of intersection.

# Onaga Trail & Hopi Trail

## ENGINEERING RECOMMENDATIONS MAP





# Onaga Trail & Sage Avenue

## LOCAL AREA PROJECT

**Onaga Trail and Sage Avenue** is a local focus area that is centrally located within the **Town of Yucca Valley** and is within one mile South of SR-62, a major E/W regional thoroughfare. Onaga Trail is an E/W two-lane corridor that bisects the focus area and provides connections therein; Sage Avenue is a N/S two-lane collector roadway that provides connections from SR-62, which is north of the focus area to residential housing in the southern sector of the focus area. Contained within the Onaga Trail and Sage Avenue are local attractors including Yucca Valley High School, religious institutions, and peripheral residential housings land uses.

**Community:** Town of Yucca Valley

**Total Cost:** \$1,991,170

### DETAILED RECOMMENDATIONS

#### Trojan Way

- Install proposed shared path 12' wide to connect Yucca Valley High School.

#### Sage Avenue

- Repaint existing school pavement marking that reads, "SLOW SCHOOL XING" North of Pueblo Trail
- Install ADA compliant driveway at the East school entrance.
- Repaint existing school pavement marking that reads, "SLOW SCHOOL XING" south of Pueblo Trail
- Repaint existing school pavement marking that reads, "SCHOOL" South of Onaga Trail

#### Sage Avenue & Pueblo Trail

- Install bulb outs at the SE and SW corner of the intersection, extending west and east respectively at Sage Avenue and Pueblo Trail
- Install shark tooth yield line 50' N/O crossing and 20' S/O crossing.
- Install R1-5 signage in-line with yield lines at the intersection.
- Repaint existing crosswalk with high visibility crossing at the South leg of the intersection.
- Install RRFB at NW and SE corners of intersection for Southbound and northbound traffic respectively.
- Install Assembly B (CA) signage facing north at SE and SW corners of the intersection.

#### Sage Avenue & Onaga Trail

- Install ADA curb ramps at NW, NE, and SW corners of intersection.
- Repaint existing crosswalk with high visibility crossing from west to east at north crossing of

intersection and north to south at west crossing of intersection.

- Install traffic signal pending warrant is passed per MUTCD.

#### Sage Avenue & Navajo Trail

- Install ADA curb ramps at NW and SW corners of intersection.

#### Sage Avenue & Mountain View Trail

- Install ADA curb ramps at NW and SW corners of intersection.

#### Onaga Trail

- Repaint existing school pavement marking that reads, "SCHOOL" between Sage Avenue and Aster Avenue
- Install transit stop enhancements 70' E/O Grand Avenue on the South side of the roadway.
- Install 700' of 8' wide sidewalk from Amador Avenue to Palm Avenue Widen roadway to full extent when installing proposed sidewalk on south side of Road

#### Onaga Trail and Palm Avenue

- Install high visibility white crosswalk for crossing at the west leg of Palm Avenue (east alignment)
- Install new pedestrian W11-2 with W16-7P signage for east and westbound approaches
- Install new advanced yield line 20'-50' prior to crossing for east and westbound approached along with R1-5 yield signage

# Onaga Trail & Sage Avenue

## ENGINEERING RECOMMENDATIONS MAP



# Palm Avenue & Sunland Drive

## LOCAL AREA PROJECT

### Palm Avenue and Sunland Drive

provides access to a central area of **Yucca Valley**. The focus area is located north of SR-62, a major E/W regional thoroughfare; Palm Avenue and Sunland Drive are local collector roads that connect to greater circulation networks. Two major recreation facilities are contained within the focus area, Pop Rauch Memorial Park and Brehm Park Family Recreation Center; a Boys and Girls Club is located centrally within the focus area and low density residential housing surrounds the focus area.

**Community:** Town of Yucca Valley

**Total Cost:** \$1,149,352

## DETAILED RECOMMENDATIONS

### Palm Avenue

- Install 309' of 8' wide sidewalk South of Sunnyslope Drive to park entrance on East side of Road
- Install ADA curb ramp at NE and SE corners of park entrances.
- Install 536' of 8' wide sidewalk to Sunland Drive on east side of Road
- Install 638' of 8' wide sidewalk from Sunland Drive to Cassia Drive on east side of Road
- Install 398' of 8' wide sidewalk from Cassia Drive to Antelope Trail on east side of Road
- Install 397' of 8' wide sidewalk south of Antelope Trail on east side of Road

### Palm Avenue & Little League Drive

- Install ADA curb ramps at NE and SE corners of intersection.
- Install white paint crosswalk for East leg of intersection.
- Install 263' of 8' wide sidewalk South towards Sunland Drive

### Palm Avenue & Cassia Drive

- Install ADA curb ramps at NE and SE corners of intersection.

### Palm Avenue & Antelope Trail

- Install ADA curb ramps at NE and SE corners of intersection.

### Little League Drive

- Install 198' of 8' wide sidewalk N/O Boys and

Girls Club facility.

- Install 154' of 8' wide sidewalk between n South side of roadway between Pop Rauch driveways
- Install 111' and 618' of 8' wide sidewalk to Grand Avenue on south side of Road in front of Pop Rauch Park.
- Install 440' of 8' wide sidewalk from Grand Avenue westward on north side of Road

### Sunland Drive & Grand Avenue

- Install ADA curb ramps at NW and SW corners of intersection.
- Install regular white paint crosswalk at the West leg of the intersection.

### Sunnyslope Drive & Park Avenue

- Install ADA curb ramp at SE corner of intersection.



# Palm Avenue & Sunland Drive

## ENGINEERING RECOMMENDATIONS MAP



# Park Boulevard & State Route 62

## LOCAL AREA PROJECT

**Park Boulevard and SR-62** focus area is located within the **Joshua Tree** downtown corridor. SR-62 forms the E/W corridor that links the area regionally, and Park Boulevard provides N/S connections to and from the Joshua Tree National Park from SR-62. Joshua Tree is the first stop for visitors to the area traveling eastbound, as such attractors are at their disposal – local traffic is also connected therein as well. These attractors include: Joshua Tree Visitor Center, Joshua Tree Community Center, Sportsman Park, transit facilities, conveniences/food options, retail shopping, and religious institutions.

**Community:** Joshua Tree

**Total Cost:** \$2,566,230

## DETAILED RECOMMENDATIONS

### Sunset Road

- Install paved shoulder from Hilltop Drive south to Alta Loma Drive

### Sunset Road & Commercial Street

- Install high visibility white crosswalk from SE to SW corner along with W11-2 and W16-7P signs.
- Install advanced yield pavement markings 20'-50' prior to crossing along with R1-5 yield signage.

### Park Boulevard

- Install paved shoulder from Plaza Road south to SR-62.

### Park Boulevard & Sunburst Circle

- Install high visibility white crosswalk from SW to SE corners along with W11-2 and W16-7P signs.
- Install advanced yield pavement markings 20'-50' prior to crossing along with R1-5 yield signage.

### Sunburst Circle

- Install proposed Class III bike route from Sunset Road to SR-62.

### Sunburst Circle & Sunset Road

- Install high visibility white crosswalk from SW to SE corners of intersection along with W11-2 and W16-7P pedestrian signage.
- Install advanced yield pavement markings 20'-50' prior to crossing along with R1-5 yield signage.

### Sunburst Circle & Easterly Drive

- Install high visibility white crosswalk from N to NE corners of intersection along with W11-2 and W16-7P pedestrian signage.
- Install advanced yield pavement markings 20'-50' prior to crossing along with R1-5 yield signage.

### Sunburst Street & Commercial Street

- Install high visibility white crosswalk for crossing across Sunburst Street from SE to SW corner along with W11-2 and W16-7P pedestrian signage.
- Install advanced yield pavement markings 20'-50' prior to crossing along with R1-5 yield signage.
- Install ADA curb ramp and Class I side path access way from roadway to path at the SE corner.

### Sunburst Street & Commercial Street

- Install high visibility white crosswalk for crossing across Sunburst Street from NE to NW corner along with W11-2 and W16-7P pedestrian signage.
- Install advanced yield pavement markings 20'-50' prior to crossing along with R1-5 yield signage.

### SR-62 & Sunset Road

- Install ADA curb ramps at SW corner of intersection; install ADA curb ramp S/O SW corner. Install ADA Curb ramp South of driveway. Install sidewalk to connect ramps.
- Extend curb (bulb out) to be in-line with existing striping at SE corner of intersection.
- Install 31' and 127' of 8' wide sidewalk along existing curb and gutter south of intersection.

### SR-62 & Park Boulevard

- Extend curb (bulb out) to be in-line with existing striping at NW and SE corners of the intersection.
- Repaint existing white crosswalk at all legs.

### SR-62 & Grand View Cir.

- Install ADA curb ramps at SW and SE corners.
- Extend same treatment used west of Park Boulevard - 2 lanes each way, bike lanes, and angle parking – further east to El Reposo.
- Install 263' of 8' wide sidewalk from Grand View Cir. and El Reposo Cir and South side of highway.
- Install 274' of 8' wide sidewalk from Grand View Cir. and Valley View Cir on South side of highway.
- Install 493' of 6' wide sidewalk between El Reposo Street and Valley View Street on North side of highway.

### SR-62 & Valley View Street

- Install ADA curb ramps at NE, SW, and SE corners.

### SR-62

- Install 271' sidewalk 6' wide from Valley View Street and Mountain View Street on North side of highway.
- Install sidewalk connection to existing bus stop along existing curb and gutter from Mountain View Street and Sunburst Street (North side of highway).
- Install 286' sidewalk 8' wide from Valley View Street and Mountain View Street on South side of highway.
- Install 252' sidewalk 8' wide from Mountain View Street to Sunburst Street on South side of highway.
- Install sidewalk connection to bus stop along curb and gutter from Sunburst Cir. and Bonair Road on South side of highway.

# Park Boulevard & State Route 62

## ENGINEERING RECOMMENDATIONS MAP

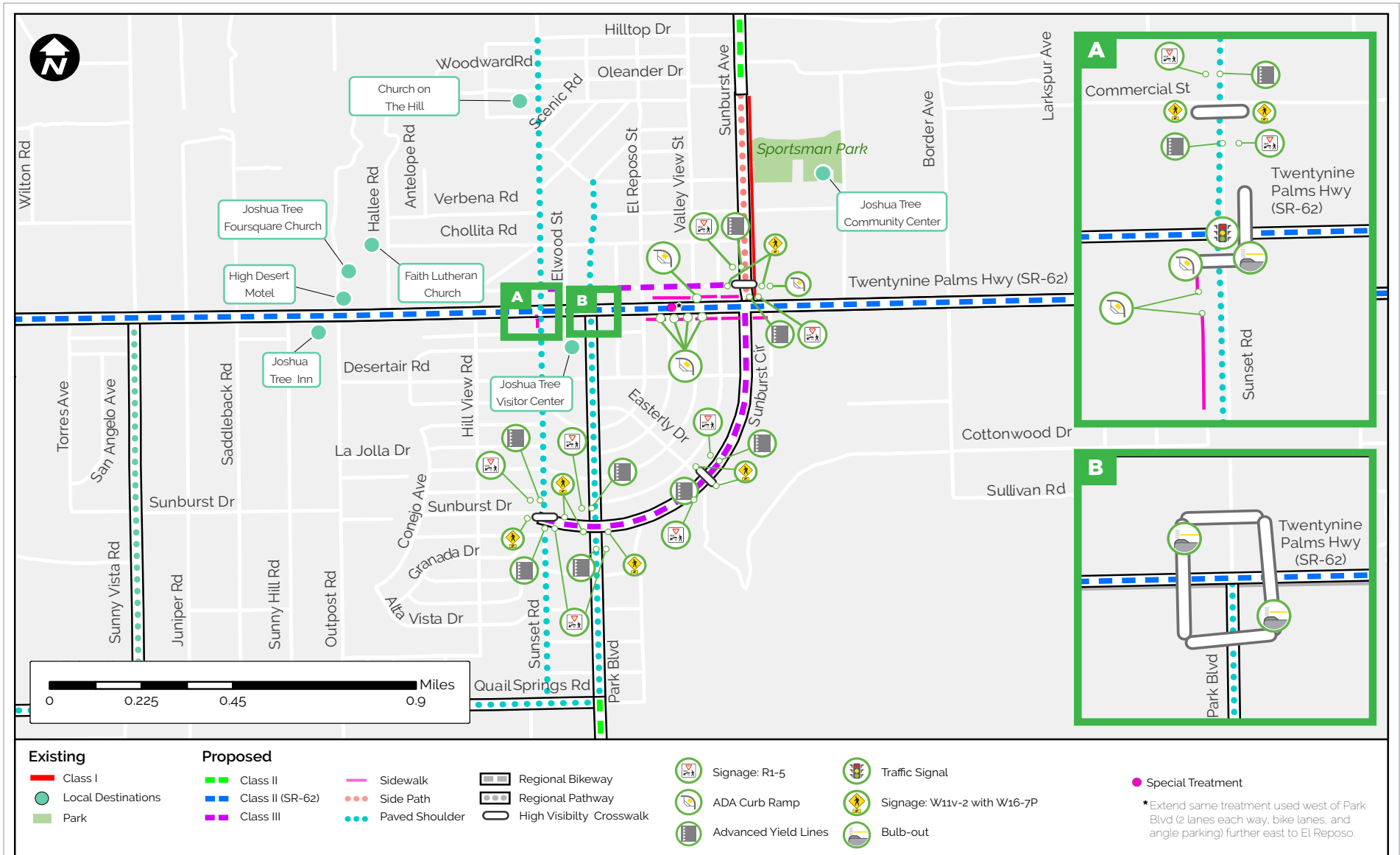

# State Route 62 & Avalon Avenue

## LOCAL AREA PROJECT

---

**SR-62 and Avalon Avenue** is located within the central area of the **Town of Yucca Valley**, along SR-62 – the major commercial corridor (Home Depot, Walmart Supercenter, conveniences/food, and transit facilities) providing connections through the focus area. Residential housing is located to the north, west, and southwest of the focus area's centroid: SR-62 and Avalon Avenue, the latter of which is a two-lane N/S arterial roadway. Paxton Road provides E/W connections north of SR-62 within the focus area extent.

**Community:** Town of Yucca Valley

**Total Cost:** \$495,678

### DETAILED RECOMMENDATIONS

#### Paxton Outerhighway N

- Install proposed pedestrian sidepath West from Hermosa Avenue to Avalon Avenue and then South towards SR-62.

#### SR-62

- Install ADA curb ramp at Walmart Supercenter entrance on North side of SR-62.
- Repaint regular white crosswalk from North to South across the highway and East to West crossing the entrance the Walmart Supercenter.



# State Route 62 & Avalon Avenue

## ENGINEERING RECOMMENDATIONS MAP

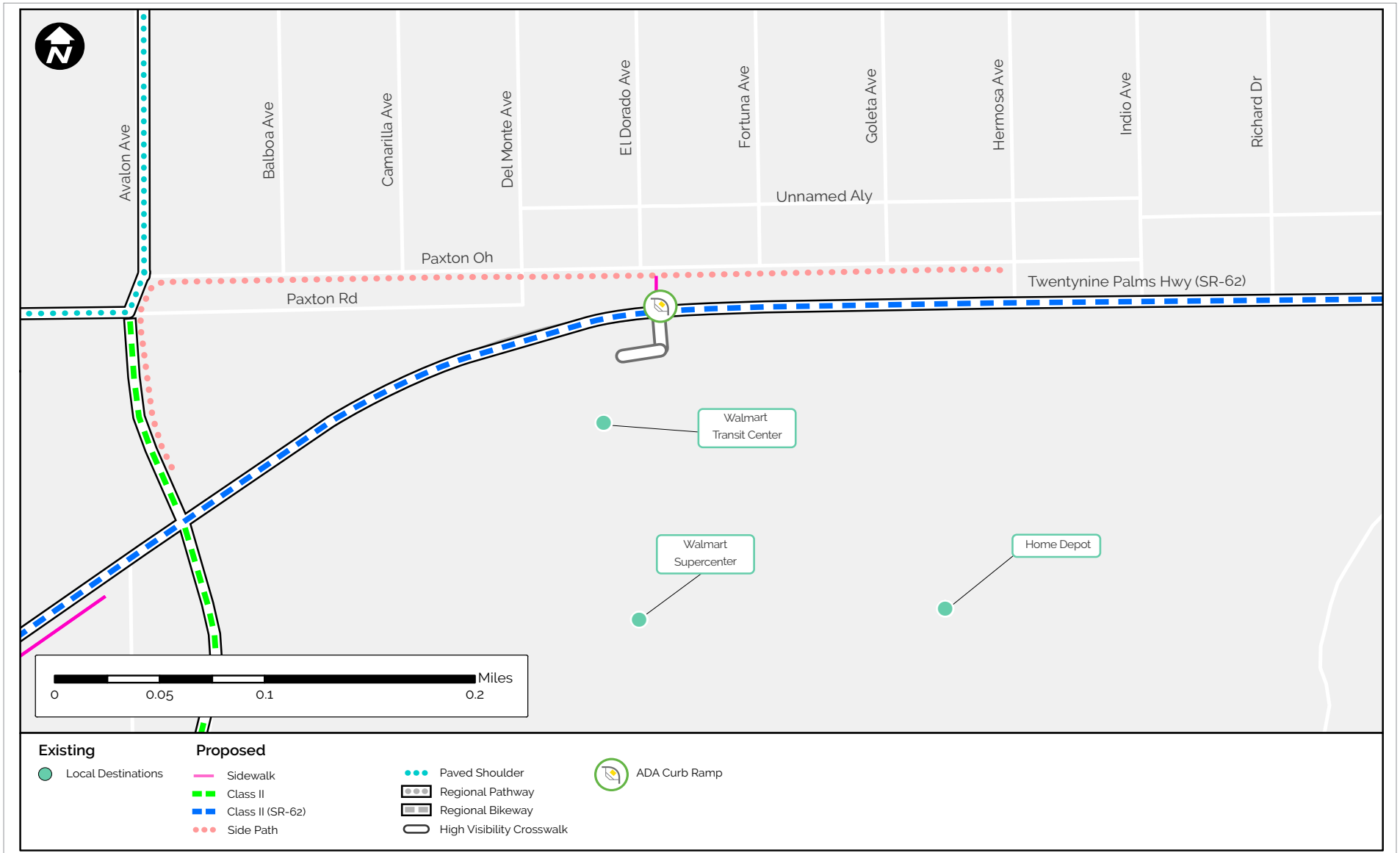

# State Route 62 & Park Avenue

## LOCAL AREA PROJECT

**SR-62 & Park Avenue** provides connections to the **Morongo Valley** area adjacent to SR-62, which is located at the western extent of the Morongo Basin as a whole. Major intersections are formed at Park Avenue and at Senilis Avenue – E/W access across SR-62 is provided at these two intersections. Local attractors that are within the bounds of the focus area are including Geeson Field Park, Covington Park, recreation Trail heads, conveniences, the Morongo Valley Community Center,

**Community:** Morongo Valley

**Total Cost:** \$1,788,713

### DETAILED RECOMMENDATIONS

#### SR-62 & Senilis Avenue

- Install ADA curb ramps at all corners of the intersection and repaint existing crosswalk at all crossings of intersection with white paint.
- Expand shoulder for proposed Class II bike lane crossing the intersection West to East.

#### SR-62 & Park Avenue

- Install new crosswalks at north, east, and west legs and repaint existing crosswalk at south legs of intersection with high visibility white paint.
- Remove existing pedestrian flashing beacon at SE corner.
- Install new pedestrian hybrid beacon and lighting at SE corner.
- Install new pedestrian hybrid beacon and lighting at SW corner.

#### Senilis Avenue, Ocotillo Street, Park Avenue, Mojave Drive, & East Drive

- Install Class III bike lane to connect recreational amenities to and from SR-62.

#### SR-62

- Install Class II bike lane 6' or greater (recommended 8' from edge of travel lane) with rumble strips and lane markings - See detailed corridor recommendations in Chapter 5.
- Install rumble strips within 2' bike lane buffer outside of urbanized area "i.e. S/O Hess Boulevard and N/O East Drive

# State Route 62 & Park Avenue

## ENGINEERING RECOMMENDATIONS MAP

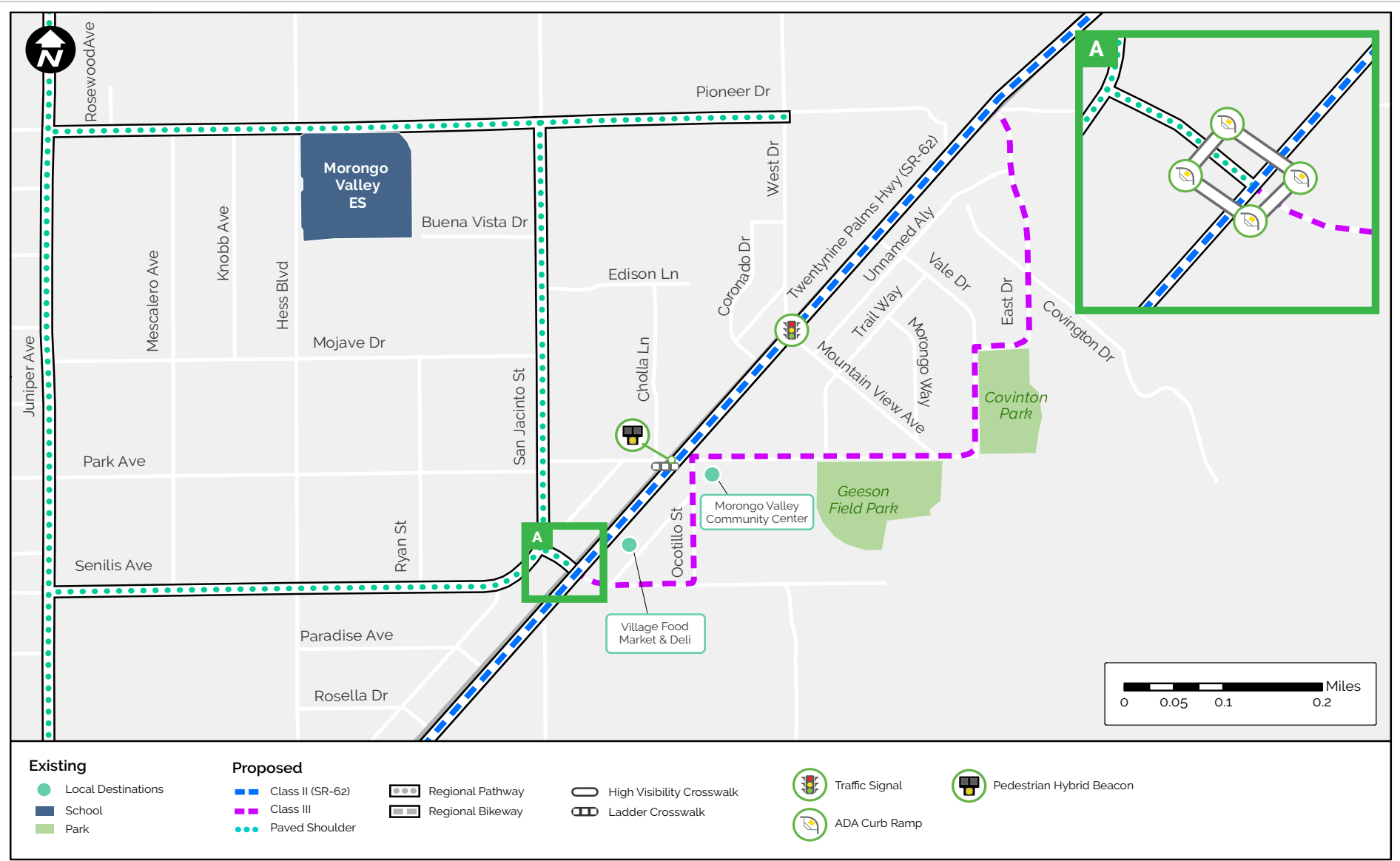

# State Route 62 & Warren Vista Drive

## LOCAL AREA PROJECT

**SR-62 and Warren Vista Drive** is a located within the central area of the **Town of Yucca Valley**, which is along SR-62 – the major E/W corridor that runs throughout the region. Warren Vista Drive, a two-lane arterial roadway, intersects SR-62 forming the centroid of the focus area. Local connections to destinations along SR-62 include: conveniences, retail shopping options, restaurants/cafes, and services.

**Community:** Town of Yucca Valley

**Total Cost:** \$889,459

### DETAILED RECOMMENDATIONS

#### Warren Vista Drive

- Install proposed paved shoulder from SR-62 to Yucca Trail

#### SR-62

- Install ADA curb ramps at West and East corner of SW entrance to Joshua Village Shopping Center.
- Install 415' of 8' wide sidewalk between SW entrance to Joshua Village Shopping Center and Airway Avenue on North side of highway.
- Install 112' of 8' wide sidewalk between Joshua Village Shopping Center south entrance and SE entrance on North side of highway.
- Install 283' of 8' wide sidewalk between Park Hill Plaza entrance and Airway Avenue on South side of highway.
- Install 557' of 8' wide sidewalk to the West of Park Hill Plaza entrance on south side of highway.
- Install transit stop enhancements at Park Hill Plaza entrance.
- Install 6' sidewalk for 511' along with enhancements between SE entrance to Joshua Village Shopping Center to McDonald's entrance on North side of highway.
- Install ADA curb ramps at West and East corners of McDonald's entrance.
- Install 229' of 8' wide sidewalk between McDonald's entrance and Warren Vista Drive on North side of highway.
- Install 402' of 8' wide sidewalk between Warren Vista Drive and shopping center entrance on North side of highway.

- Install ADA curb ramps at West and East corners of shopping center entrance
- Install 6' wide sidewalk for 245' along with enhancements between Dryden Avenue and Dedicated Dryden Avenue on South side of highway.
- Install 464' of 8' wide sidewalk between South shopping center entrance and Dryden Avenue on North side of highway.
- Install ADA curb ramps at West and East corner of SE shopping center entrance.
- Install 410' of 8' wide sidewalk between SE shopping center entrance and Hilton Road on North side of highway.

#### SR-62 & Warren Vista Drive

- Install ADA curb ramps at NW, NE, and SE corners of intersection.
- Replace regular crosswalk with white paint high visibility crosswalk at all legs of the intersection (N, S, E, and W).



# State Route & Warren Vista Drive

## ENGINEERING RECOMMENDATIONS MAP

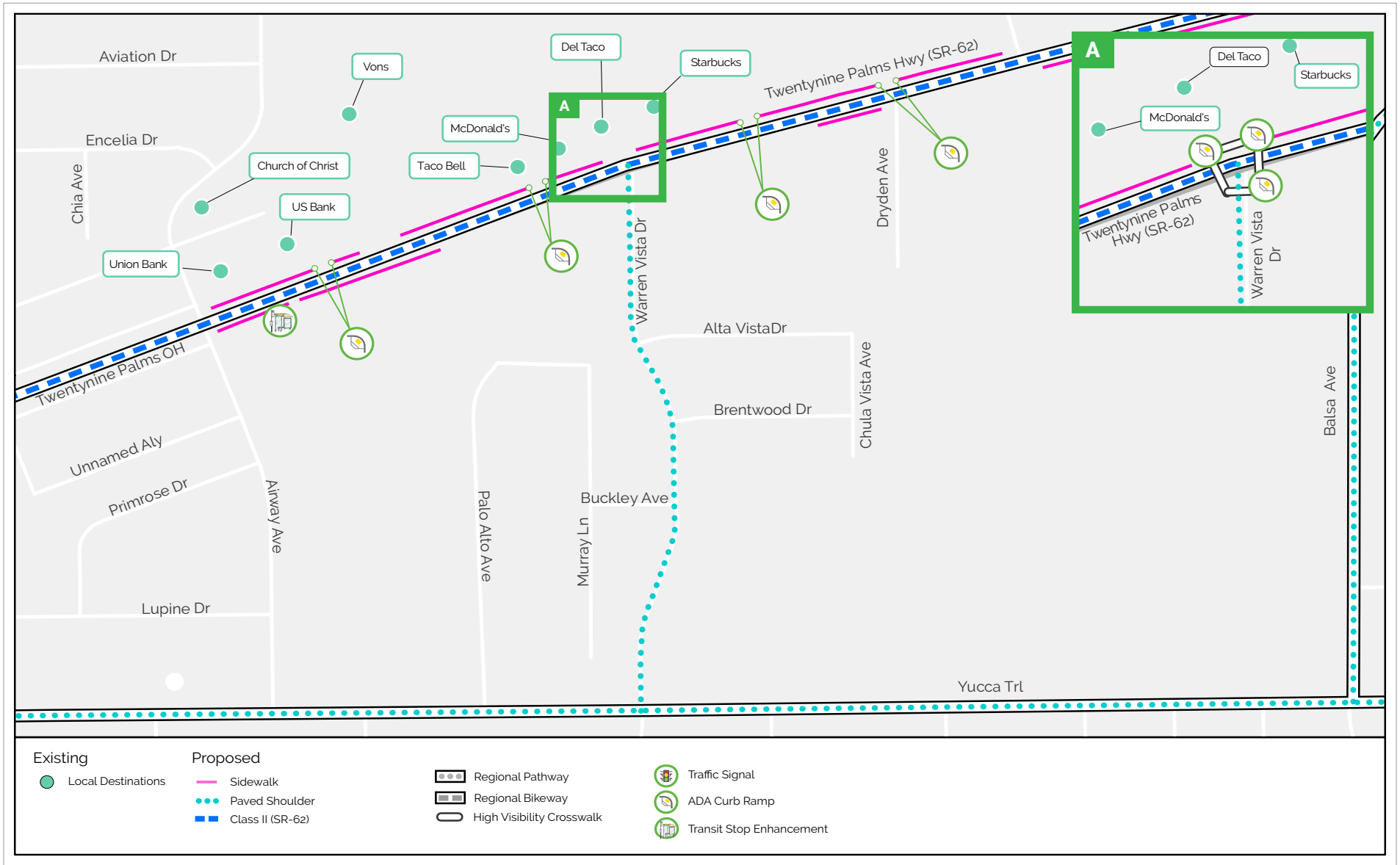

# Sullivan Road & El Sol Avenue (Knott's Sky Park)

## LOCAL AREA PROJECT

**Sullivan Road & El Sol Avenue (Knott's Sky Park)** is a focus area within the **City of Twentynine Palms** (western sector) that provides access along El Sol Avenue and Sullivan Avenue. El Sol Avenue is a N/S collector roadway that links to SR-62 major corridor, intersecting also Hatch Road, which forms the focus area's E/W mid-point bisecting corridor. Sullivan Road is an E/W oriented roadway that connects local residential housing to Knott's Sky Park, the local recreation facility. Commercial conveniences are located proximal to SR-62 towards the northern edge of the focus area.

**Community:** City of Twentynine Palms

**Total Cost:** \$631,272

## DETAILED RECOMMENDATIONS

### Sullivan Road

- Install proposed Class III bike route from Morongo Road East towards El Sol Avenue
- Install bus stop enhancements West of El Sol Avenue on North side of roadway.

### El Sol Avenue

- Install proposed Class II bike lane from SR-62 South towards Hatch Road
- Install proposed Class III bike route from Hatch Road South toward Foothill Drive
- Install 1,190' of 8' wide sidewalk South of Hatch Road on East side of Road
- Install 814' of 8' wide sidewalk South of Sullivan Road on East side of Road

### Hatch Road

- Install transit facility enhancements between El Sol Avenue and La Luna Avenue on North side of Road

### Hatch Road & El Sol Avenue

- Install high visibility white crosswalk for crossing across Hatch Road from SE to NE corner.
- Install new pedestrian W11-2 and W16-7P signs along with new Hatch Road crosswalk.
- Install new advanced yield markings 20'-50' prior to crossing for approaching traffic movements not controlled by a stop control device
- Install new R1-5 yield sign along with new advanced yield lines.

# Sullivan Road & El Sol Avenue (Knott's Sky Park)

## ENGINEERING RECOMMENDATIONS MAP



# Yucca Trail & Airway Avenue

## LOCAL AREA PROJECT

**Yucca Trail and Airway Avenue** is a central area within the **Town of Yucca Valley**, which is located just South of the major regional thoroughfare. Local connections are provided along two-lane collector and arterial roadways: Yucca Trail (E/W), Airway Avenue (N/S), and Joshua Lane (N/S). Attractors that are within the focus area include the Yucca Valley Transit Center, U.S. Post Office, and commercial conveniences along SR-62.

**Community:** Town of Yucca Valley

**Total Cost:** \$810,009

### DETAILED RECOMMENDATIONS

#### SR-62

- Connect existing sidewalk and bus stops to close gaps between Joshua Ln. and Airway Avenue on South side of highway.
- Install 6' sidewalk along with enhancements between Joshua Ln. and Airway Avenue on North side of highway.

#### Airway Avenue & SR-62 Outer Hwy.

- Install ADA curb ramps at NW and SW corners of intersection.
- Install 74' of 8' wide sidewalk South of intersection on West side of Road

#### Airway Avenue & SR-62

- Remove existing R9-3 signage and install pedestrian push buttons at the NE, SE, and SW corners or the intersection.
- Install new white paint high visibility crosswalk at the south and east leg of the intersection and repaint existing crosswalks at the west and north legs.

#### Airway Avenue & Primrose Drive

- Install ADA curb ramps at NW and SW corners of intersection.
- Install 163' of 8' wide sidewalk North of intersection on West side of Road

#### Airway Avenue

- Install 534' of 8' wide sidewalk between Primrose Drive and Lupine Drive on West side of Road
- Install 288' of 8' wide sidewalk between Lupine

Drive and Yucca Trail on West side of Road

#### Airway Avenue & Lupine Drive

- Install ADA curbs ramps at NW and SW corners of intersection.

#### Airway Avenue & Yucca Trail

- Install ADA curb ramp at NE corner of intersection.

#### Yucca Trail

- Install 524' of 8' wide sidewalk to the East of Airway Avenue on North side of Road
- Install 523' of 8' wide sidewalk between Yucca Valley Transit Center and Lupine Drive on north side of Road
- Install ADA curb ramps at West and East corners at SE entrance to Yucca Trail & Joshua Ln. Post Office.
- Install transit stop enhancements at SW entrance of Yucca Trail & Joshua Ln. Post Office.

#### Yucca Trail & Lupine Drive

- Install ADA curb ramps at NW and NE corners of intersection.



# Yucca Trail & Airway Avenue

## ENGINEERING RECOMMENDATIONS MAP

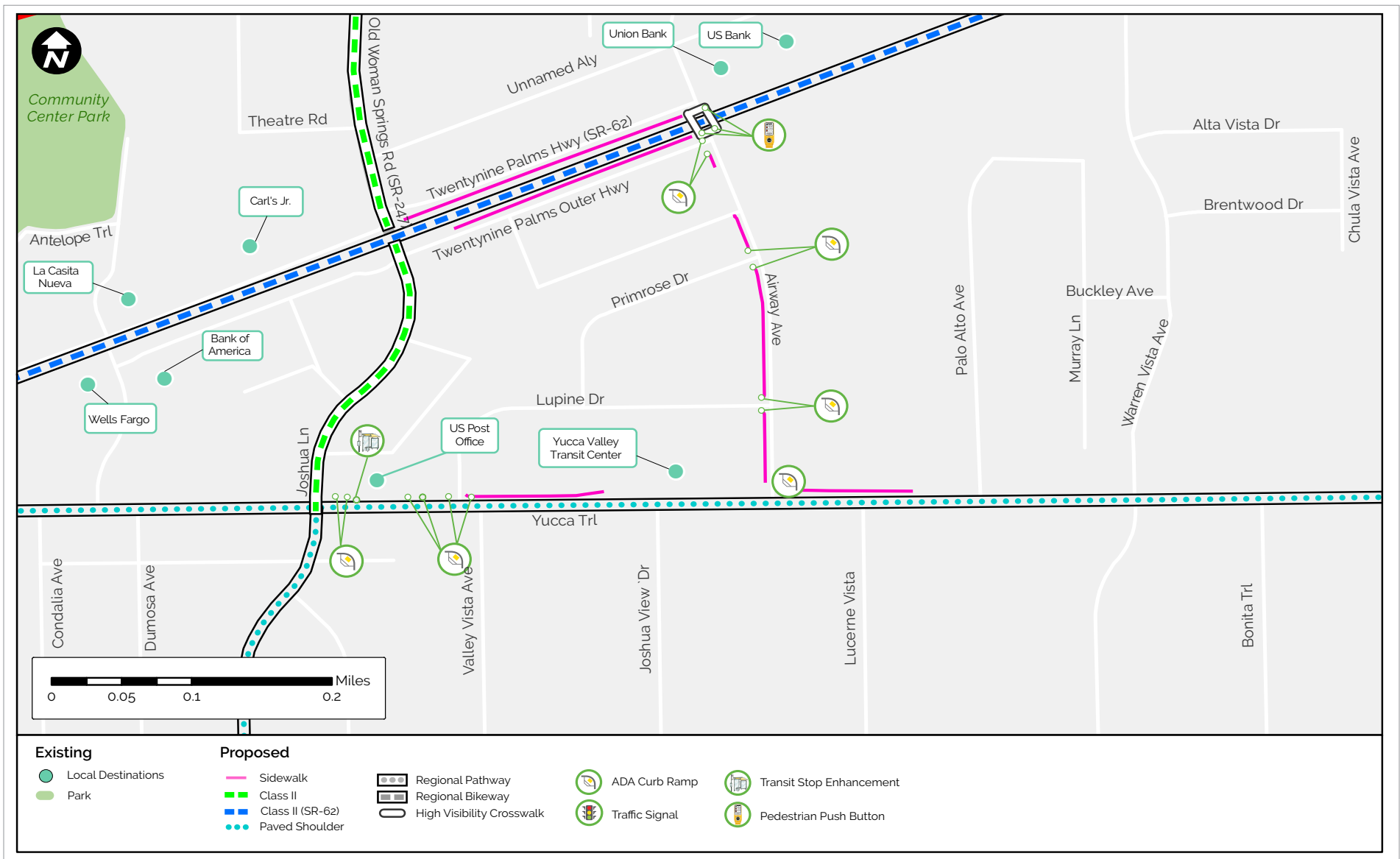

# Yucca Valley Town Hall & County Library

## LOCAL AREA PROJECT

**Yucca Valley Town Hall & County Library** is a core area within the **Town of Yucca Valley**, proximal to SR-62, the region's major E/W thoroughfare. Locally connections are provided via a network of collector roadways: Dumosa Avenue, Antelope Trail, Barberry Avenue, and Sage Avenue. Commercial uses (restaurants, banks, retail, and conveniences) are provided along SR-62 within the focus area extents. Furthermore, the Yucca Valley Town Hall, Yucca Valley Branch San Bernardino County Library, Hi-Desert Nature Museum, Community Center Park, transit facilities, and the Yucca Valley BMX Park are contained within the focus area.

**Community:** Town of Yucca Valley

**Total Cost:** \$627,886

### DETAILED RECOMMENDATIONS

#### N/O Community Center Park

- Install proposed shared pedestrian path from flood channel N/O Community Center Park to North parking lot for Park facility.

#### Dumosa Avenue

- Install proposed Class III bike lane extending north of SR-62 to Community Center Park north entrance.

#### Barberry Avenue

- Install 1,393' of 8' wide sidewalk from Cassia Drive to Antelope Trail on the East side of the roadway and then eastward along the North side of Antelope Trail towards the Community Center Park.
- Install 254' of 8' wide sidewalk from the alley south of Antelope Trail to SR-62 on East side of Road

#### Barberry Avenue & Antelope Trail

- Install ADA curb ramps at NE and SE corners of intersection.

#### Antelope Trail

- Install 692' of 8' wide sidewalk from 430' W/O Dumosa Avenue west to Barberry Avenue on the south side of the Road to Alley Alley on east side of Road
- Install 163' of 8' wide sidewalk on West side of the North entrance to Community Center Park.
- Install 189' of 8' wide sidewalk on the East side of the South entrance to Community Center Park on north side of Road

#### SR-62

- Install truncated domes on existing curb ramps on west and east end of SW, South, and SE entrances of Desert Hills Plaza Shopping Center.

# Yucca Valley Town Hall & County Library

## ENGINEERING RECOMMENDATIONS MAP

